

# ITEMNO.:ZECCA PE3H

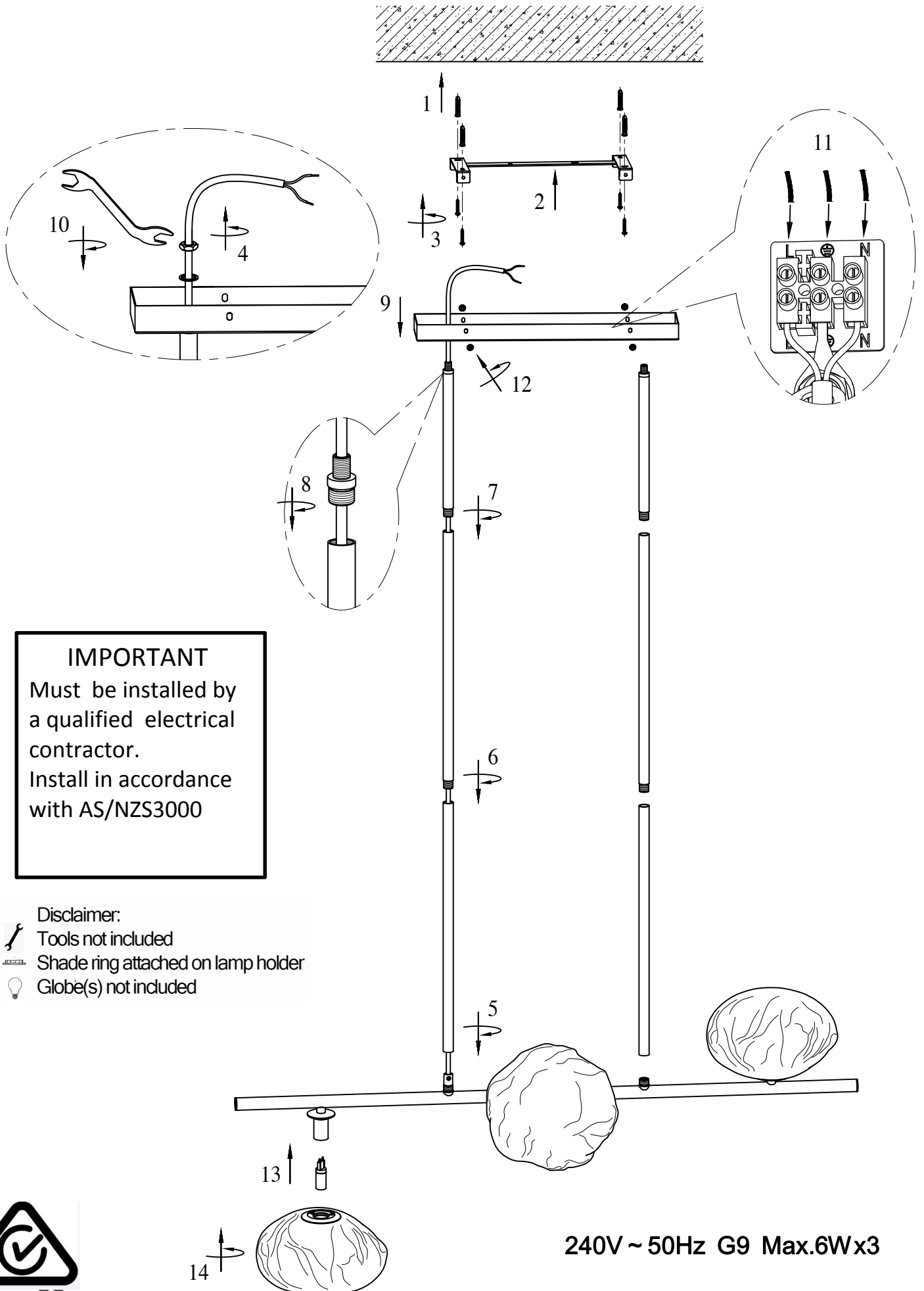

**IMPORTANT**  
Must be installed by  
a qualified electrical  
contractor.  
Install in accordance  
with AS/NZS3000

- Disclaimer:  
/ Tools not included  
 Shade ring attached on lamp holder  
 Globe(s) not included



240V ~ 50Hz G9 Max.6Wx3

NOTE: GLOBE NOT INCLUDED