

## SHADOW-2-ADJ

### Double Adjustable Wall Light



#### Description

The SHADOW Series 2 Light Adjustable Wall Light offers a durable weatherproof solution to lighting up larger areas where ambient lighting is required. Available in solid finishes (316 Stainless Steel and Copper), Anodised Titanium Silver Aluminium and Powder coated Aluminium (Textured Black and White). Suits a GU10 lamp. Backed by a 3 Year Warranty, and now available in 240V or 12V.

#### Specification Features

- Input Voltage: 240V or 12V\* DC
- Power (W): 2 x 35W Max
- IP rating (IP): 65
- Tilt & Swivel: 90° & 270°
- Lamp (Included): KEY-GU10-TRIO (240V)  
KEY-MR16-TRIO (12V)

\*Requires a 12V DC driver.



White



Titanium Silver



Copper



Stainless Steel



Bronze



Brass

#### Diagrams / Additional

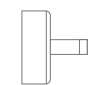
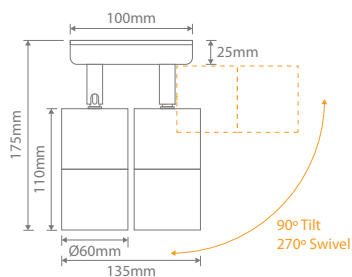

Aluminium models



Stainless Steel & Copper models

Item No.	Variant	Colour	Lamp
SHADOW-2-ADJ	49056	Black	TRIO
	49057	White	
	49058	Titanium Silver	
	49059	Copper	
	49060	316 Stainless Steel	
	49062	Bronze	
49064	Brass		

Item No.	Variant	Colour	Lamp
SHADOW-2-ADJ-LV	10914	Black	TRIO
	10915	White	
	10916	Titanium Silver	
	10917	Copper	
	10918	316 Stainless Steel	
	10919	Bronze	
	10920	Brass	

Included Lamp

KEY-GU10-TRIO 65112