

Ashton LED Wall Light Installation Guide

We strongly recommend that you read this manual carefully before installation.
Installation MUST be carried out by a qualified and licensed electrician.



Replacement
Warranty

Models Parameters

MLXA34510W 10W LED Wall Light IP54 Tricolour White
MLXA34510M 10W LED Wall Light IP54 Tricolour Matt Black

Installation Instructions

Step 1

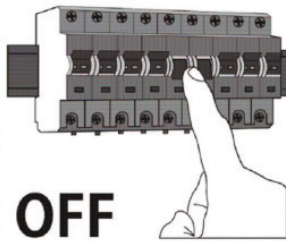

OFF

Switch off the mains.

Step 2

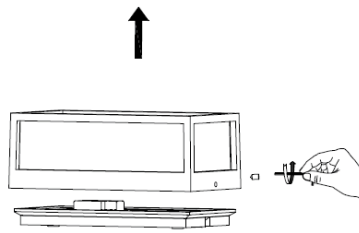

Unscrew and remove the mounting bracket using the allen key supplied.

Step 3

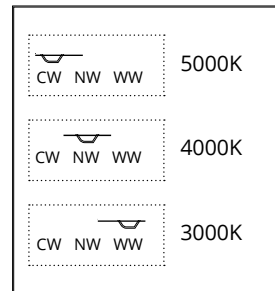

Choose colour temperature by flicking the switch.

Step 4

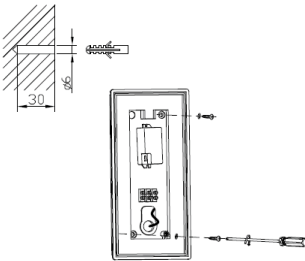

Mount the bracket on the desired surface using the two screws supplied.

Step 5

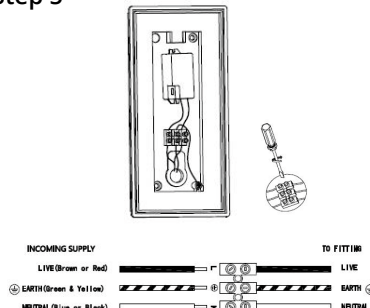

Wire to main as illustrated above.

Step 6

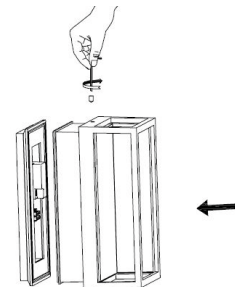

Attach fitting back onto the bracket using the allen key supplied.

Step 7

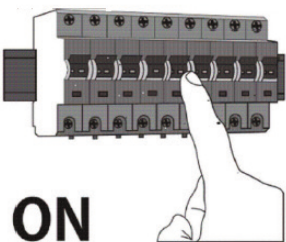

ON

Switch on the mains.

Accessories Included

1x allen key
2x washers
2x wall plugs
2x screws

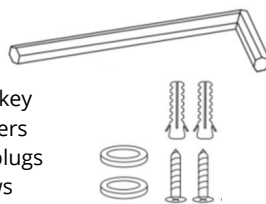

Ashton LED Wall Lights Installation Guide

Data Table

Models	Power (W)	PF	CCT (K)	Weight (KG)	Operation Temperature (Degree)	IP
MLXA34510W	10	≥ 0.5	3000 4000 5000	0.75	+40° -20°	54
MLXA34510M	10	≥ 0.5	3000 4000 5000	0.75	+40° -20°	54

WARNING

- Installation of product **MUST** follow SAA standards and meet local authority regulations.
- Installation **MUST** be carried out by a qualified and licensed electrician.
- Light **MUST** be earthed.
- Light **MUST** be firmly installed to a flat solid surface, wall or ceiling.
- **DO NOT** immerse any part of the light fitting into water or any form of liquid.
- **DO NOT** look directly into the LED light.
- The warranty is **VOID** if product is not installed according to this installation guide.

2 Year Replacement Warranty

Visit our website for details <https://www.martecaustralia.com.au/warranty-statement/>

