

## Installation Manual

### MODULA

Order Code	Product Code	Description
19420	MODULA-9-RND-WW	9W LED inground light, 3000K Warm White
19421	MODULA-9-RND-W	9W LED inground light, 5000K White
19422	MODULA-9-SQR-WW	9W LED inground light, 3000K Warm White
19423	MODULA-9-SQR-W	9W LED inground light, 5000K White

Thank you for purchasing your new LED MODULA (Round and Square), Please take the time to read and understand the instruction sheet below. Failure to do so may void warranty.

### Specifications

Voltage:	24V DC*	Lumen (±5%):	Warm White 3000K - 900lm White 5000K - 950lm	Dimmable:	No
Power:	9W	Beam Angle:	45°	CRI:	≥83
IP Rating:	65	CCT:	3000K - 5000K	Lifespan:	50,000hrs

\*Requires 24V DC Constant Voltage LED Driver - Wire in Parallel.

### Method of connection/s:

- Soldering or wire crimping is the preferred method of connection.
- Don't use block connectors/ wire nut connectors or any other connectors.
- Use approved heat shrink sealer for the inner sections where the two inner wires emerge and also the total outer section.
- Don't leave wires unsealed.
- Don't use PVC insulation tape as a sealer as this does not work.
- Don't use silicon as a method of sealing.
- Please use the correct cable gauge for all LED garden light fittings.
- It is recommended to use 0.75mm, 2 core rubberised flex or 1.5mm, 2 core rubberised flex.
- It is recommended to use 1000V rated cable.
- Don't use TPS (thermal plastic sheathing) twin or twin and earth.
- Don't use FIG8 low voltage garden cable.
- For any further information regarding installation/s please contact your local dealer.

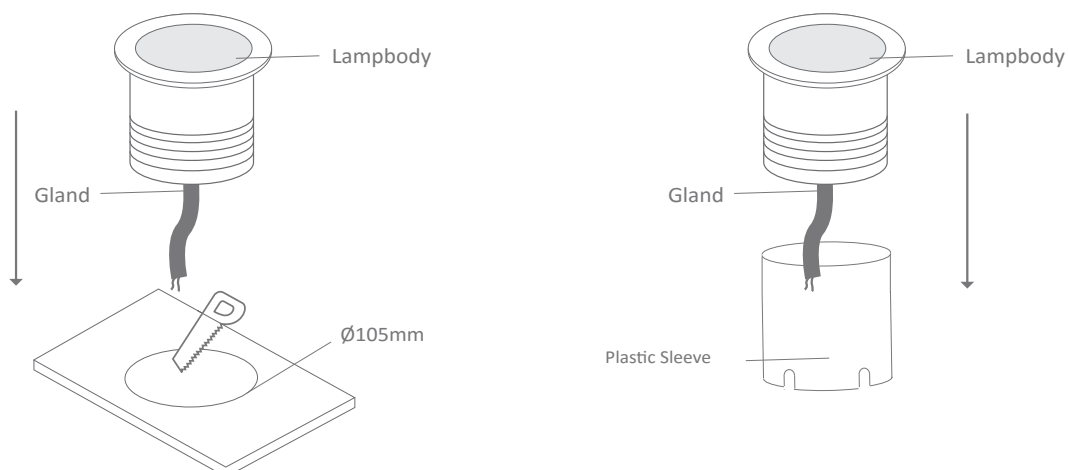

**Note:** -The lamp must be installed by professional electrician  
-Ensure the power supply is switched off before fitting this product

-Do not touch the lamp when in use  
-Keep away from hot steam and corrosive gas