

ALBAST SERIES · EXTERIOR WALL LIGHT

HV8079T-BLK + HV8079T-BR

Aluminium Black or Solid Brass Wall Light



NAME	Albast
DIMENSIONS	(H)300 X (W)77 X (D)105
INSTALLATION TYPE	Wall - Surface Mounted
INPUT VOLTAGE	240V AC · 50Hz
PROTECTION CLASS	1 - Earth Required
LED	2X 9W G9
COLOUR TEMP.	3000k or 4000K
IP RATING	IP65
IK RATING	IK04
BODY	Powder-Coated Aluminium or Solid Brass
DIMMABLE	No
APPROVALS	
WARRANTY	3 Years Replacement

IMPORTANT — READ BEFORE INSTALLATION

This is a 240V mains-voltage fitting. In Australia and New Zealand, fixed mains wiring must be carried out by a licensed electrician in accordance with AS/NZS 3000 (Wiring Rules). Do not attempt to wire or connect this product yourself.

1 Important Safety Issues

- Installation must be carried out by a licensed electrician in accordance with AS/NZS 3000 wiring rules.
- Ensure mains power is disconnected before installation.
- Do not modify the fitting in any way, as this will void warranty.
- Ensure all seals, gaskets, and cable entries are correctly installed to maintain IP rating.
- Aluminium fittings should not be installed within 5km of saltwater environments.
- Failure to correctly seal the fitting may allow water ingress and void warranty.
- Before drilling, cutting, or installing, ensure there are no concealed electrical cables, water pipes, or gas lines behind the mounting surface.
- Do not install the fitting on surfaces subject to excessive vibration or movement.
- The fitting must not be covered with insulation material or combustible materials.
- Do not install near heat sources, gas appliances, or areas with excessive ambient temperatures.
- Ensure the mains supply voltage matches the product rating of 240V AC.
- Disconnect power immediately if the fitting becomes damaged, cracked, or exposed to moisture internally.
- Solid Brass Material will naturally Tarnish when exposed to the outdoor elements an is not considered as a product defect.
- This product contains electronic components that must not be disposed of with general household waste.
- Maintain all IP65 seals and gaskets during installation to prevent water ingress.
- Suitable for wall mounting only. Do not install in-ground, underwater, or fully submerged applications.
- Avoid direct high-pressure water exposure from pressure washers or irrigation systems.
- Ensure drainage is maintained and the fitting is not installed in locations where water can pool around cable entries.
- Do not energise the fitting while partially assembled.
- Keep packaging materials away from children during installation.
- Allow fitting to cool before handling if recently operated.
- Isolate power before cleaning, maintenance, or inspection.
- Failure to follow installation instructions may result in electric shock, fire hazard, product failure, or voided warranty.
- Alabaster glass is a handcrafted material and may exhibit natural variations in colour, pattern, opacity, and texture. These characteristics are inherent to the material and are not considered defects.
- Visit www.havit.com.au for full Warranty Terms & Conditions.

2 Technical Specifications

PART NUMBERS	COLOUR TEMP.	LUMEN OUTPUT	INCLUDED LED	INPUT
HV8079T-BLK	3000K	2x 270lm	2x 9w · G9 LED	240V AC
HV8079T-BR	4000K	2x 285lm		

CONSTRUCTION

Body material	Aluminium or Solid Brass
Finish	Poly powder-coated Black or Brass
Fixings	Stainless grub screws
Backing plate	Supplied

RATINGS

Ingress protection	IP65
Total power	2x 9W
Beam direction	120°
Suitability	Indoor / Outdoor

3 Product Dimensions

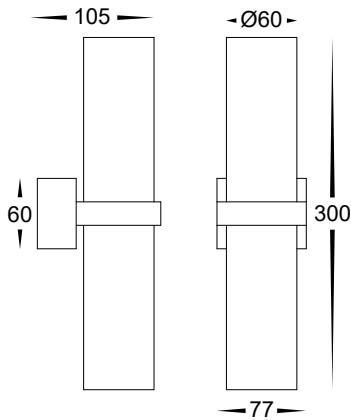

Overall height	300 mm
Body diameter	Ø60mm
Mounting plate (W x H)	72 x 55mm
Mounting hole spacing	36mm (V) x 54mm (H)
Cable entry	Ø13mm
Mounting holes	4x Ø4mm

**All dimensions are nominal and in millimetres.
Verify against the physical product before drilling.**

4 Safety Warnings

! IMPORTANT — READ BEFORE INSTALLATION

This is a 240V mains-voltage fitting. In Australia and New Zealand, fixed mains wiring must be carried out by a licensed electrician in accordance with AS/NZS 3000 (Wiring Rules). Do not attempt to wire or connect this product yourself.

Isolate mains power and lock-off / tag the circuit before wiring.

Confirm the supply matches the rating: 240V AC, 50Hz.

Do not connect a damaged fitting. Inspect the body, lens and gasket before install.

The integrated LED is not user-replaceable; do not open the sealed LED module.

Maintain the IP65 seal — fit the supplied gasket and seal the cable entry correctly.

5 In the Box

SUPPLIED

1 × HV8079T-BLK or HV8079T-BR Light Fitting

1 × Matching backing plate - Attached to Fitting

Stainless steel grub screws - Attached to Fitting

Sealing gasket - Attached to Backing Plate

2x wall plugs

2.5mm hex (allen) key

6 Mounting Template

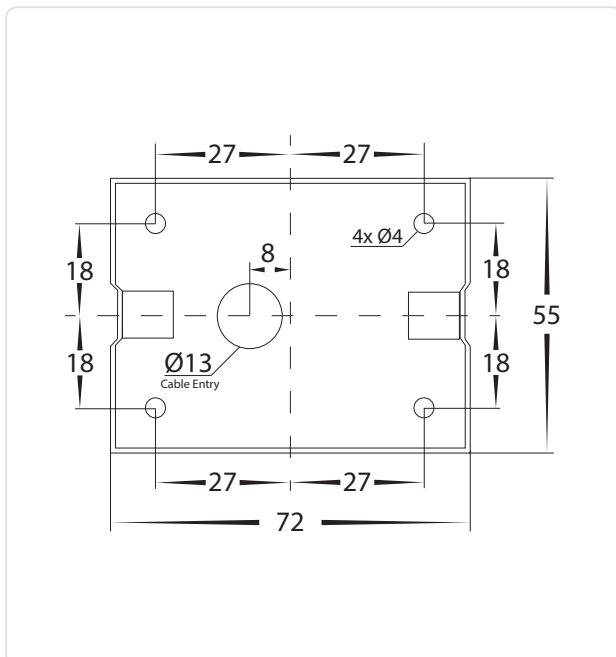

The mounting bracket has two Ø4 mm fixing holes set diagonally and a central Ø11 mm cable entry. Mark the wall using the plate itself, or transfer the dimensions shown:

Bracket Size WxH	72x55
Mounting holes	4 × Ø4mm
Hole offset from centre	8mm Horizontal
Hole offset from centre	Centred
Cable entry diameter	Ø13mm

i NOTE

Diagram is not to scale when printed. Always verify dimensions against the physical backing plate before drilling.

7 Installation Procedure

1 Isolate the Power

Switch off the circuit at the switchboard, lock-off / tag it, and confirm the wiring is de-energised with a voltage tester.

2 Remove Backing Plate

Remove the mounting bracket. Loosen the retaining screws and separate the mounting bracket from the fitting body.

3 Mark & Prepare Surface

Use the mounting bracket (or template) to mark the fixing holes and cable entry. Drill and insert wall plugs..

4 Feed the Supply Cable

Route the mains cable through the cable entry / gland. Fit the gasket to maintain the IP54 seal against the wall.

5 Secure the backing plate

Fix the plate flush and level. Apply exterior silicone around side edges, and to all fixing points and the cable entry, for outdoor installs.

6 Connect the wiring

Electrician connects Active, Neutral & Earth to the matching terminals (see below) and confirms tight, insulated joints.

7 Mount the body

Tuck excess cable behind the fitting, locate the body onto the plate and lock with the stainless grub screws. Apply exterior silicone around side edges to avoid water ingress into baseplate.

8 Globe Selection

Select either 3000k or 4000k Globes, Remove Alabaster Covers by twisting Anti Clockwise and set aside, Insert Globes into lampholders by aligning pins and pushing in gently, Reattach covers by twisting clockwise making sure seals are still in place. If Globe needs replacing follow same steps making sure new globes do not exceed the max wattage

9 Restore power & test

Re-energise and confirm both up and down LEDs illuminate. Check the fitting is secure and sealed.

TERMINAL BLOCK

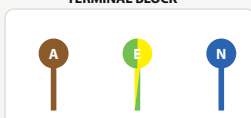

WIRING CONNECTIONS

Connect supply to matching terminals. Conductor colours per AS/NZS 3000:

■ Active — Brown

■ Earth — Green/Yellow

■ Neutral — Blue

8 Maintenance & Care

Always isolate power before cleaning or inspecting the fitting.

Wipe the body and lens with a soft, damp cloth — avoid solvents and abrasives that may damage the powder-coat finish.

Periodically check the gasket is intact and the fitting remains sealed, especially in exposed locations.

Inspect nuts are secure and the body has not loosened over time.

9 Troubleshooting

SYMPTOM	POSSIBLE CAUSE	ACTION
Light does not turn on	Circuit not energised / wiring loose	Confirm power is on and have the electrician check terminal connections.
Only one direction working	Internal connection / faulty module	Isolate power, re-seat the body; if it persists, lodge a warranty claim.
Flickering	Loose connection or supply issue	Electrician to check connections and supply stability.
Wrong colour temperature	Change Globes	Isolate, remove body and replace globes.
Moisture inside lens	Compromised IP65 seal	Check gasket seating and cable gland sealing; re-seal as needed.

9 Warranty

<p>3 YEARS</p> <p>REPLACEMENT WARRANTY</p>	<p>IP65</p> <p>INGRESS PROTECTION</p>	<p>240V</p> <p>MAINS INPUT</p>
---	--	---------------------------------------

This product carries a 3-year replacement warranty from Havit Lighting. Warranty applies to the original purchaser and is subject to correct installation by a licensed electrician and normal use in accordance with these instructions. Full warranty terms & conditions and product registration are available at havit.com.au. Retain your proof of purchase.

REGISTER YOUR PRODUCT

Register your purchase and access data sheets, IES files and the latest installation documents at havit.com.au/pages/resources.



143 Beauchamp Road, Matraville NSW 2036
 Phone: +61 (02) 9381 8300
 Email: Sales@havit.com.au
 Web: havit.com.au



Warranty Terms & Conditions



www.havit.com.au