

## LOKA SERIES · EXTERIOR WALL LIGHT

# HV3519W-BLK + HV3519W-WHT

Aluminium Black or White Wall Light



NAME	Loka
DIMENSIONS	Ø250 Shade · 410 Proj · 305 H mm
INSTALLATION TYPE	Wall - Surface Mounted
INPUT VOLTAGE	240V AC · 50Hz
PROTECTION CLASS	1 - Earth Required
LED	8W E27
COLOUR TEMP.	2700K
IP RATING	IP54
IK RATING	IK04
BODY	Powder-Coated Aluminium
DIMMABLE	Yes - Triac
APPROVALS	
WARRANTY	3 Years Replacement

### **!** IMPORTANT — READ BEFORE INSTALLATION

This is a 240V mains-voltage fitting. In Australia and New Zealand, fixed mains wiring must be carried out by a licensed electrician in accordance with AS/NZS 3000 (Wiring Rules). Do not attempt to wire or connect this product yourself.

## 1 Important Safety Issues

- Installation must be carried out by a licensed electrician in accordance with AS/NZS 3000 wiring rules.
- Ensure mains power is disconnected before installation.
- Do not modify the fitting in any way, as this will void warranty.
- Ensure all seals, gaskets, and cable entries are correctly installed to maintain IP rating.
- Aluminium fittings should not be installed within 5km of saltwater environments.
- Failure to correctly seal the fitting may allow water ingress and void warranty.
- Before drilling, cutting, or installing, ensure there are no concealed electrical cables, water pipes, or gas lines behind the mounting surface.
- Do not install the fitting on surfaces subject to excessive vibration or movement.
- The fitting must not be covered with insulation material or combustible materials.
- Do not install near heat sources, gas appliances, or areas with excessive ambient temperatures.
- Ensure the mains supply voltage matches the product rating of 240V AC.
- Disconnect power immediately if the fitting becomes damaged, cracked, or exposed to moisture internally.
- This product contains electronic components that must not be disposed of with general household waste.
- Maintain all IP54 seals and gaskets during installation to prevent water ingress.
- Suitable for wall mounting only. Do not install in-ground, underwater, or fully submerged applications.
- Avoid direct high-pressure water exposure from pressure washers or irrigation systems.
- Ensure drainage is maintained and the fitting is not installed in locations where water can pool around cable entries.
- Do not energise the fitting while partially assembled.
- Keep packaging materials away from children during installation.
- Allow fitting to cool before handling if recently operated.
- Isolate power before cleaning, maintenance, or inspection.
- Failure to follow installation instructions may result in electric shock, fire hazard, product failure, or voided warranty.
- Visit [www.havit.com.au](http://www.havit.com.au) for full Warranty Terms & Conditions.

## 2 Technical Specifications

PART NUMBERS	COLOUR TEMP.	LUMEN OUTPUT	INCLUDED LED	INPUT
HV3519W-BLK HV3519W-WHT	2700K	700lm	8W E27	240V AC

### CONSTRUCTION

Body material	Aluminium
Finish	Poly powder-coated Black or White
Fixings	Stainless grub screws
Backing plate	Supplied

### RATINGS

Ingress protection	IP54
Total power	8W
Beam direction	120°
Suitability	Outdoor

## 3 Product Dimensions

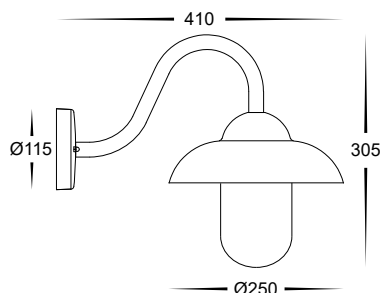

Shade diameter	Ø250 mm
Wall plate diameter	Ø 115 mm
Overall projection from wall	410mm
Mounting hole spacing	61 mm (vertical)
Overall height	211mm
Form	Gooseneck dome, downward

**All dimensions are nominal and in millimetres.  
Verify against the physical product before drilling.**

## 4 Safety Warnings

### ! IMPORTANT — READ BEFORE INSTALLATION

This is a 240V mains-voltage fitting. In Australia and New Zealand, fixed mains wiring must be carried out by a licensed electrician in accordance with AS/NZS 3000 (Wiring Rules). Do not attempt to wire or connect this product yourself.

Isolate mains power and lock-off / tag the circuit before wiring.

Confirm the supply matches the rating: 240V AC, 50Hz.

Do not connect a damaged fitting. Inspect the body, lens and gasket before install.

The integrated LED is not user-replaceable; do not open the sealed LED module.

Maintain the IP54 seal — fit the supplied gasket and seal the cable entry correctly.

## 5 In the Box

### SUPPLIED

1 × HV3519W-BLK or HV3519W-WHT Light Fitting

Sealing gasket - Attached to Backing Plate

1 × Matching backing plate - Attached to Fitting

2x wall plugs

## 6 Mounting Template

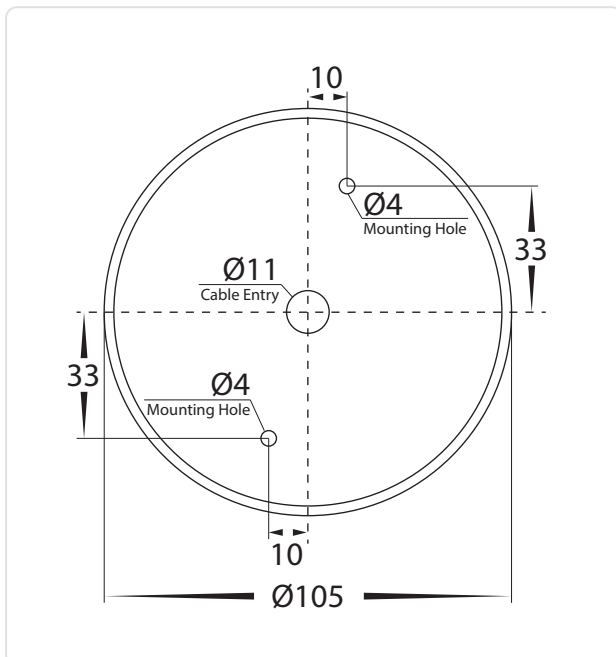

The mounting bracket has two Ø4 mm fixing holes set diagonally and a central Ø11 mm cable entry. Mark the wall using the plate itself, or transfer the dimensions shown:

Bracket diameter	Ø105mm
Mounting holes	2 × Ø4mm
Hole offset from centre	10mm horizontal
Hole offset from centre	33mm vertical
Cable entry diameter	Ø11 mm (central)

### i NOTE

Diagram is not to scale when printed. Always verify dimensions against the physical backing plate before drilling.

## 7 Installation Procedure

- 1 Isolate the Power**

Switch off the circuit at the switchboard, lock-off / tag it, and confirm the wiring is de-energised with a voltage tester.
- 2 Remove Glass & Globe**

Remove the glass then globe by twisting anti-clockwise and set aside. This will avoid any damage that may be caused during installation.
- 3 Remove Backing Plate**

Remove the mounting bracket. Loosen the retaining screws and separate the mounting bracket from the fitting body.
- 4 Mark & Prepare Surface**

Use the mounting bracket (or template) to mark the fixing holes and cable entry. Drill and insert wall plugs..
- 5 Feed the Supply Cable**

Route the mains cable through the cable entry / gland. Fit the gasket to maintain the IP54 seal against the wall.
- 6 Secure the backing plate**

Fix the plate flush and level. Apply exterior silicone around side edges, and to all fixing points and the cable entry, for outdoor installs.
- 7 Connect the wiring**

Electrician connects Active, Neutral & Earth to the matching terminals (see below) and confirms tight, insulated joints.
- 8 Mount the body**

Tuck excess cable behind the fitting, locate the body onto the plate and secure with the supplied nuts.
- 9 Reattach Glass and Insert Globe**

Insert globe into lampholder and twist clockwise until tight, Reattach Glass by inserting into thread and slowly twist clockwise until tight, Do not over-tighten; doing so may strip the thread and result in the glass loosening or falling from the fitting which will not be covered under warranty.
- 10 Restore power & test**

Re-energise and confirm globe illuminates. Check the fitting is secure and sealed.

### TERMINAL BLOCK

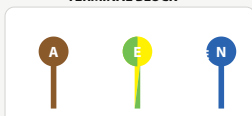

### WIRING CONNECTIONS

Connect supply to matching terminals. Conductor colours per AS/NZS 3000:

Active — Brown
  Earth — Green/Yellow
  Neutral — Blue

## 8 Maintenance & Care

Always isolate power before cleaning or inspecting the fitting.

Wipe the body and lens with a soft, damp cloth — avoid solvents and abrasives that may damage the powder-coat finish.

Periodically check the gasket is intact and the fitting remains sealed, especially in exposed locations.

Inspect nuts are secure and the body has not loosened over time.

## 9 Troubleshooting

SYMPTOM	POSSIBLE CAUSE	ACTION
Light does not turn on	Circuit not energised / wiring loose	Confirm power is on and have the electrician check terminal connections.
Light does not turn on	Check globe	Tighten globe
Flickering	Loose connection or supply issue	Electrician to check connections and supply stability.
Moisture inside lens	Compromised IP54 seal	Check gasket seating and cable gland sealing; re-seal as needed.

## 9 Warranty

<p><b>3 YEARS</b> REPLACEMENT WARRANTY</p>	<p><b>IP54</b> INGRESS PROTECTION</p>	<p><b>240V</b> MAINS INPUT</p>
--	---	------------------------------------

This product carries a 3-year replacement warranty from Havit Lighting. Warranty applies to the original purchaser and is subject to correct installation by a licensed electrician and normal use in accordance with these instructions. Full warranty terms & conditions and product registration are available at [havit.com.au](http://havit.com.au). Retain your proof of purchase.

### REGISTER YOUR PRODUCT

Register your purchase and access data sheets, IES files and the latest installation documents at [havit.com.au/pages/resources](http://havit.com.au/pages/resources).



143 Beauchamp Road, Matraville NSW 2036  
 Phone: +61 (02) 9381 8300  
 Email: [Sales@havit.com.au](mailto:Sales@havit.com.au)  
 Web: [havit.com.au](http://havit.com.au)



Warranty Terms & Conditions



[www.havit.com.au](http://www.havit.com.au)