

ARKUA SERIES • EXTERIOR WALL LIGHT

HV3518T-BLK + HV3518T-WHT

Aluminium Black or White Wall Light



NAME	Arkua
DIMENSIONS	Ø250 Shade • 410 Proj • 211 H mm
INSTALLATION TYPE	Wall - Surface Mounted
INPUT VOLTAGE	240V AC • 50Hz
PROTECTION CLASS	1 - Earth Required
LED	10W • Built-in
COLOUR TEMP.	TRI Colour • 3000K / 4000K / 5500K
IP RATING	IP54
IK RATING	IK04
BODY	Powder-Coated Aluminium
DIMMABLE	No
APPROVALS	
WARRANTY	3 Years Replacement

IMPORTANT — READ BEFORE INSTALLATION

This is a 240V mains-voltage fitting. In Australia and New Zealand, fixed mains wiring must be carried out by a licensed electrician in accordance with AS/NZS 3000 (Wiring Rules). Do not attempt to wire or connect this product yourself.

1 Important Safety Issues

- Installation must be carried out by a licensed electrician in accordance with AS/NZS 3000 wiring rules.
- Ensure mains power is disconnected before installation.
- Do not modify the fitting in any way, as this will void warranty.
- Ensure all seals, gaskets, and cable entries are correctly installed to maintain IP rating.
- Aluminium fittings should not be installed within 5km of saltwater environments.
- Failure to correctly seal the fitting may allow water ingress and void warranty.
- Before drilling, cutting, or installing, ensure there are no concealed electrical cables, water pipes, or gas lines behind the mounting surface.
- Do not install the fitting on surfaces subject to excessive vibration or movement.
- The fitting must not be covered with insulation material or combustible materials.
- Do not install near heat sources, gas appliances, or areas with excessive ambient temperatures.
- Ensure the mains supply voltage matches the product rating of 240V AC.
- Disconnect power immediately if the fitting becomes damaged, cracked, or exposed to moisture internally.
- Do not attempt to replace the built-in LED module, as it is non-serviceable.
- This product contains electronic components that must not be disposed of with general household waste.
- Maintain all IP54 seals and gaskets during installation to prevent water ingress.
- Suitable for wall mounting only. Do not install in-ground, underwater, or fully submerged applications.
- Avoid direct high-pressure water exposure from pressure washers or irrigation systems.
- Ensure drainage is maintained and the fitting is not installed in locations where water can pool around cable entries.
- Do not energise the fitting while partially assembled.
- Keep packaging materials away from children during installation.
- Allow fitting to cool before handling if recently operated.
- Isolate power before cleaning, maintenance, or inspection.
- Failure to follow installation instructions may result in electric shock, fire hazard, product failure, or voided warranty.
- Visit www.havit.com.au for full Warranty Terms & Conditions.

2 Technical Specifications

PART NUMBERS	COLOUR TEMP.	LUMEN OUTPUT	INCLUDED LED	INPUT
HV3518T-BLK HV3518T-WHT	3000K	740lm	10W · Built-in LED	240V AC
	4000K	805lm		
	5500K	760lm		

CONSTRUCTION

Body material	Aluminium
Finish	Poly powder-coated Black or White
Fixings	Stainless grub screws
Backing plate	Supplied

RATINGS

Ingress protection	IP54
Total power	10W
Beam direction	120°
Suitability	Outdoor

3 Product Dimensions

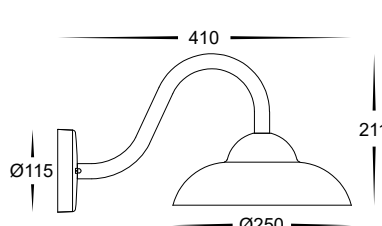

Shade diameter	Ø250 mm
Wall plate diameter	Ø 115 mm
Overall projection from wall	410mm
Mounting hole spacing	61 mm (vertical)
Overall height	211mm
Form	Gooseneck dome, downward

**All dimensions are nominal and in millimetres.
Verify against the physical product before drilling.**

4 Safety Warnings

! IMPORTANT — READ BEFORE INSTALLATION

This is a 240V mains-voltage fitting. In Australia and New Zealand, fixed mains wiring must be carried out by a licensed electrician in accordance with AS/NZS 3000 (Wiring Rules). Do not attempt to wire or connect this product yourself.

Isolate mains power and lock-off / tag the circuit before wiring.

Confirm the supply matches the rating: 240V AC, 50Hz.

Do not connect a damaged fitting. Inspect the body, lens and gasket before install.

The integrated LED is not user-replaceable; do not open the sealed LED module.

Maintain the IP54 seal — fit the supplied gasket and seal the cable entry correctly.

5 In the Box

SUPPLIED

1 × HV3518T-BLK or HV3518T-WHT Light Fitting

Sealing gasket - Attached to Backing Plate

1 × Matching backing plate - Attached to Fitting

2x wall plugs

6 Mounting Template

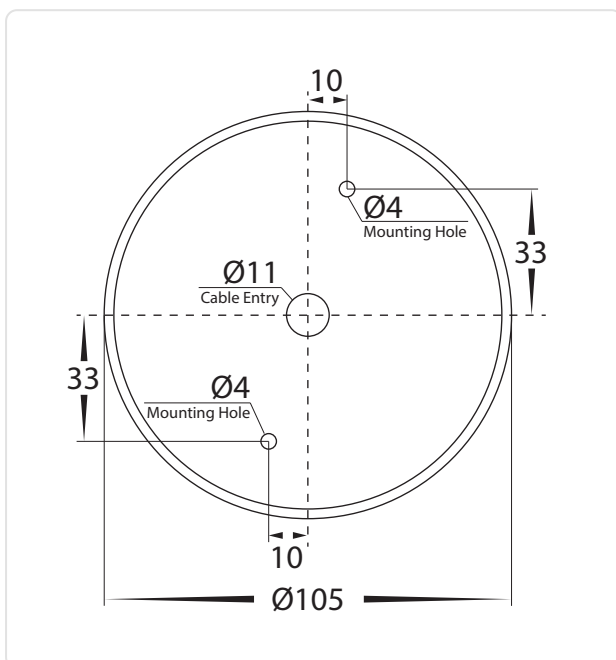

The mounting bracket has two Ø4 mm fixing holes set diagonally and a central Ø11 mm cable entry. Mark the wall using the plate itself, or transfer the dimensions shown:

Bracket diameter	Ø105mm
Mounting holes	2 × Ø4mm
Hole offset from centre	10mm horizontal
Hole offset from centre	33mm vertical
Cable entry diameter	Ø11 mm (central)

i NOTE

Diagram is not to scale when printed. Always verify dimensions against the physical backing plate before drilling.

7 Installation Procedure

TRI-COLOUR SELECTOR



SET COLOUR TEMPERATURE FIRST

Use the TRI-colour selector switch on the fitting to choose 3000K, 4000K or 5500K **BEFORE** mounting. Match all fittings on the same façade for a consistent look.

1

Isolate the Power

Switch off the circuit at the switchboard, lock-off / tag it, and confirm the wiring is de-energised with a voltage tester.

2

Remove Backing Plate

Remove the mounting bracket. Loosen the retaining screws and separate the mounting bracket from the fitting body.

3

Mark & Prepare Surface

Use the mounting bracket (or template) to mark the fixing holes and cable entry. Drill and insert wall plugs..

4

Feed the Supply Cable

Route the mains cable through the cable entry / gland. Fit the gasket to maintain the IP54 seal against the wall.

5

Secure the backing plate

Fix the plate flush and level. Apply exterior silicone around side edges, and to all fixing points and the cable entry, for outdoor installs.

6

Connect the wiring

Electrician connects Active, Neutral & Earth to the matching terminals (see below) and confirms tight, insulated joints.

7

Mount the body

Tuck excess cable behind the fitting, locate the body onto the plate and secure with the supplied nuts.

8

Select Colour Temperature

Set the TRI-colour switch to your chosen CCT located inside PC Cover. To remove cover, Twist Anti Clockwise.

9

Restore power & test

Re-energise and confirm both up and down LEDs illuminate. Check the fitting is secure and sealed.

TERMINAL BLOCK

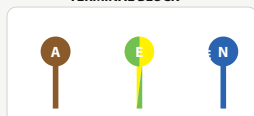

WIRING CONNECTIONS

Connect supply to matching terminals. Conductor colours per AS/NZS 3000:

 Active — Brown  Earth — Green/Yellow  Neutral — Blue

8 Maintenance & Care

Always isolate power before cleaning or inspecting the fitting.

Wipe the body and lens with a soft, damp cloth — avoid solvents and abrasives that may damage the powder-coat finish.

Periodically check the gasket is intact and the fitting remains sealed, especially in exposed locations.

Inspect nuts are secure and the body has not loosened over time.

9 Troubleshooting

SYMPTOM	POSSIBLE CAUSE	ACTION
Light does not turn on	Circuit not energised / wiring loose	Confirm power is on and have the electrician check terminal connections.
Only one direction working	Internal connection / faulty module	Isolate power, re-seat the body; if it persists, lodge a warranty claim.
Flickering	Loose connection or supply issue	Electrician to check connections and supply stability.
Wrong colour temperature	TRI-colour switch position	Isolate, remove body and reset the CCT selector switch.
Moisture inside lens	Compromised IP54 seal	Check gasket seating and cable gland sealing; re-seal as needed.

9 Warranty

<p>3 YEARS</p> <p>REPLACEMENT WARRANTY</p>	<p>IP54</p> <p>INGRESS PROTECTION</p>	<p>240V</p> <p>MAINS INPUT</p>
---	--	---------------------------------------

This product carries a 3-year replacement warranty from Havit Lighting. Warranty applies to the original purchaser and is subject to correct installation by a licensed electrician and normal use in accordance with these instructions. Full warranty terms & conditions and product registration are available at havit.com.au. Retain your proof of purchase.

i REGISTER YOUR PRODUCT

Register your purchase and access data sheets, IES files and the latest installation documents at havit.com.au/pages/resources.



143 Beauchamp Road, Matraville NSW 2036
 Phone: +61 (02) 9381 8300
 Email: Sales@havit.com.au
 Web: havit.com.au



Warranty Terms & Conditions



www.havit.com.au