

## PRISMA · EXTERIOR BOLLARD LIGHT

# HV1641W-BLK + HV1642W-BLK

## Aluminium Black Bollard Lights



HV1641W-BLK

HV1642W-BLK

<b>NAME</b>	<b>Prisma</b>
<b>DIMENSIONS</b>	<b>Ø120 x 670mm or 970mm</b>
<b>INSTALLATION TYPE</b>	<b>Ground - Surface Mounted</b>
<b>INPUT VOLTAGE</b>	<b>240v AC</b>
<b>PROTECTION CLASS</b>	<b>1 - Earth Required</b>
<b>LED</b>	<b>8w E27</b>
<b>COLOUR TEMP.</b>	<b>2700K</b>
<b>IP RATING</b>	<b>IP65</b>
<b>IK RATING</b>	<b>IK08</b>
<b>BODY</b>	<b>Powder-Coated Aluminium</b>
<b>DIMMABLE</b>	<b>Yes - Triac Dimmable</b>
<b>WARRANTY</b>	<b>3 Years Replacement</b>

### ⚠ IMPORTANT — READ BEFORE INSTALLATION

This is a 240V mains-voltage fitting. In Australia and New Zealand, fixed mains wiring must be carried out by a licensed electrician in accordance with AS/NZS 3000 (Wiring Rules). Do not attempt to wire or connect this product yourself.

## 1 Important Safety Issues

- Installation must be carried out by a licensed electrician in accordance with AS/NZS 3000 wiring rules.
- Ensure mains power is disconnected before installation.
- Do not modify the fitting in any way, as this will void warranty.
- Ensure all seals, gaskets, and cable entries are correctly installed to maintain IP rating.
- Aluminium fittings should not be installed within 5km of saltwater environments.
- Failure to correctly seal the fitting may allow water ingress and void warranty.
- Before drilling, cutting, or installing, ensure there are no concealed electrical cables, water pipes, or gas lines behind the mounting surface.
- Do not install the fitting on surfaces subject to excessive vibration or movement.
- The fitting must not be covered with insulation material or combustible materials.
- Do not install near heat sources, gas appliances, or areas with excessive ambient temperatures.
- Ensure the mains supply voltage matches the product rating of 240V AC.
- Disconnect power immediately if the fitting becomes damaged, cracked, or exposed to moisture internally.
- Do not attempt to replace the built-in LED module, as it is non-serviceable.
- This product contains electronic components that must not be disposed of with general household waste.
- Maintain all IP65 seals and gaskets during installation to prevent water ingress.
- When installing surface mounted bollards, base plate must be installed on concrete or concrete pad, Fitting should not be installed under ground level
- Avoid direct high-pressure water exposure from pressure washers or irrigation systems.
- Ensure drainage is maintained and the fitting is not installed in locations where water can pool around cable entries.
- Do not energise the fitting while partially assembled.
- Keep packaging materials away from children during installation.
- Allow fitting to cool before handling if recently operated.
- Isolate power before cleaning, maintenance, or inspection.
- Failure to follow installation instructions may result in electric shock, fire hazard, product failure, or voided warranty.
- Visit [www.havit.com.au](http://www.havit.com.au) for full Warranty Terms & Conditions.

## 2 Technical Specifications

PART NUMBERS	COLOUR TEMP.	LUMEN OUTPUT	INCLUDED LED	INPUT
HV1641W-BLK HV1642W-BLK	2700K	700lm	8W · E27 LED	24V DC

### CONSTRUCTION

Body material	Aluminium
Finish	Poly powder-coated Black
Fixings	Mounting Base

### RATINGS

Ingress protection	IP65
Total power	8W
Beam direction	360°
Suitability	Outdoor

## 3 Product Dimensions

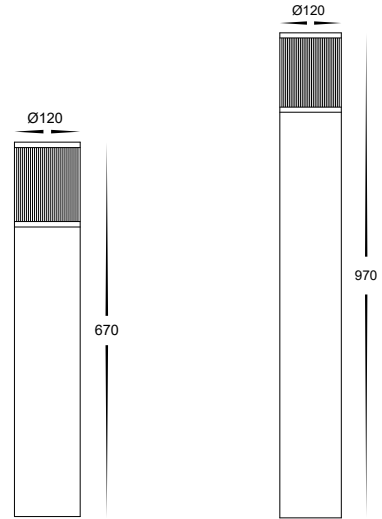

Overall height	670mm or 970mm
Post diameter	Ø120mm
Mounting Base Size	Ø113

**All dimensions are nominal and in millimetres.  
Verify against the physical product before drilling.**

## 4 Safety Warnings

### ! IMPORTANT — READ BEFORE INSTALLATION

This is a 240V mains-voltage fitting. In Australia and New Zealand, fixed mains wiring must be carried out by a licensed electrician in accordance with AS/NZS 3000 (Wiring Rules). Do not attempt to wire or connect this product yourself.

Isolate mains power and lock-off / tag the circuit before wiring.

Confirm the supply matches the rating: 240V

Do not connect a damaged fitting. Inspect the body, lens and cable before install.

Fitting is supplied with a Male + Female connector - Do not remove

Fitting is supplied a Anti Water Syphon - Do not remove

## 5 In the Box

### SUPPLIED

1 x HV1641W-BLK or HV1642W Light Fitting

1 x Mounting Base - Attached to Fitting

4 x Dynabolts

Male + Female connector - On Cable

Anti Water Syphon - On Cable

1x Allen Key

## 6 Mounting Template

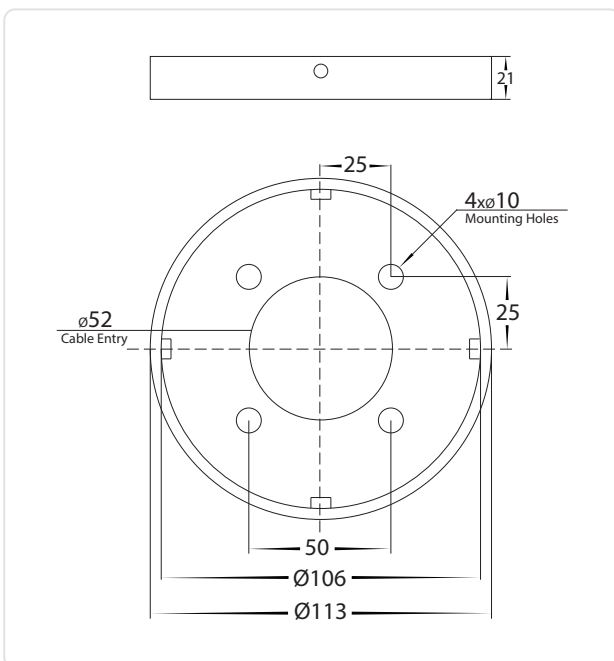

The mounting bracket has two Ø4 mm fixing holes set diagonally and a central Ø11 mm cable entry. Mark the wall using the plate itself, or transfer the dimensions shown:

Bracket diameter	Ø113mm
Mounting holes	4 x Ø10mm
Hole offset from centre	25mm horizontal
Hole offset from centre	25mm vertical
Cable entry diameter	Ø52mm (central)

### i NOTE

Diagram is not to scale when printed. Always verify dimensions against the physical backing plate before drilling.

## 7 Do Not Remove

These fittings are supplied with both a male and female connector and an anti-water syphon fitted to the cable. The male and female connector allows for easy replacement of the fitting if required, without the need to redo the main connection point. The anti-water syphon helps prevent water from travelling through the cable and reaching the light source, which may cause product failure. Both the connector and anti-water syphon must remain fitted and must not be removed during installation. Removal of either component will void the product warranty.



## 8 Installation Procedure

### 1 Isolate the Power

Switch off the circuit at the switchboard, lock-off / tag it, and confirm the wiring is de-energised with a voltage tester.

### 2 Remove Mounting Base

Remove Mounting Base from fitting by using Allen Key supplied and loosen the 4x Allen Screws located at bottom of fitting and set aside

### 3 Mark & Prepare Surface

Use the mounting bracket as a template to mark the fixing holes and cable entry point. Drill the required holes, insert the Dynabolts, and tighten securely. Once tightened, remove the nuts from the Dynabolts and set them aside for later use.

### 4 Feed the Supply Cable

Route the mains cable through the cable entry.

### 5 Connect the wiring

Locate the IP-rated junction box inside the fitting. Loosen the screws on the junction box and remove the cover.

Feed the mains cable through the cable gland of the junction box. If the cable is not circular, the cable entry must be properly sealed to maintain the IP rating.

A licensed electrician must connect the Active, Neutral, and Earth wires to the corresponding terminals, as shown below, and ensure all connections are secure.

Once the connections have been completed and checked, refit the junction box cover and tighten the screws securely.

### 6 Mount the body

Tuck excess cable inside the fitting, locate the body onto the mounting plate and secure with allen screws set aside earlier. Make sure these are tight to prevent any movement in bollard

### 7 Restore power & test

Re-energise and confirm LED illuminates. Check the fitting is secure and sealed.

## 8 Replacing LED Globe

### 1 Isolate the Power

Switch off the circuit at the switchboard, lock-off / tag it, and confirm the wiring is de-energised with a voltage tester.

### 2 Remove Head from Post

Remove Head from post by loosening Allen Screws on side of fitting.

### 3 Removing and Inserting New Globe

To remove the globe, gently hold the outer section and twist it anti-clockwise until loosened. Insert the new globe and twist clockwise until it is firmly secured in place. Ensure the replacement globe does not exceed the maximum wattage rating shown on the fitting label.

### 4 Reattach Head to Post

Carefully place the head onto the post, ensuring all seals remain correctly positioned. Tighten the Allen screws securely and check that the head is firmly attached to the post.

TERMINAL BLOCK

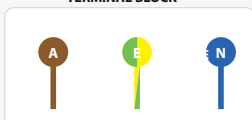

### WIRING CONNECTIONS

Connect supply to matching terminals. Conductor colours per AS/NZS 3000:

 Active — Brown

 Earth — Green/Yellow

 Neutral — Blue

## 9 Maintenance & Care

Always isolate power before cleaning or inspecting the fitting.

Wipe the body and lens with a soft, damp cloth — avoid solvents and abrasives that may damage the powder-coat finish.

Periodically check the cable is intact and the fitting remains sealed, especially in exposed locations.

## 10 Troubleshooting

SYMPTOM	POSSIBLE CAUSE	ACTION
Light does not turn on	Circuit not energised / wiring loose	Confirm power is on and have the electrician check terminal connections.
Flickering	Loose connection or supply issue	Electrician to check connections and supply stability.
Moisture inside lens	Compromised IP65 seal	Check Diffuser is sealed and all connections are cover.

## 11 Warranty

**3 YEARS**

REPLACEMENT WARRANTY

**IP65**

INGRESS PROTECTION

**240v AC**

MAINS INPUT

This product carries a 3-year replacement warranty from Havit Lighting. Warranty applies to the original purchaser and is subject to correct installation by a licensed electrician and normal use in accordance with these instructions. Full warranty terms & conditions and product registration are available at [havit.com.au](http://havit.com.au). Retain your proof of purchase.

### REGISTER YOUR PRODUCT

Register your purchase and access data sheets, IES files and the latest installation documents at [havit.com.au/pages/resources](http://havit.com.au/pages/resources).



143 Beauchamp Road, Matraville NSW 2036  
 Phone: +61 (02) 9381 8300  
 Email: [Sales@havit.com.au](mailto:Sales@havit.com.au)  
 Web: [havit.com.au](http://havit.com.au)



Warranty Terms & Conditions



[www.havit.com.au](http://www.havit.com.au)