

# 240V LED STRIP INSTALLATION INSTRUCTIONS

PART NUMBER	COLOUR TEMP.	WATTAGE P/M
HCP-3825053	3000K	5W
HCP-3825054	4000K	5W
HCP-3764086	6500K	5W
HCP-3825123	3000K	12W
HCP-3825124	4000K	12W
HCP-3764126	6500K	12W

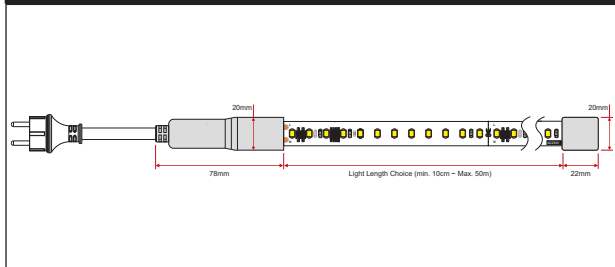

## LED STRIP DIMENSIONS



## END CAP DIMENSIONS

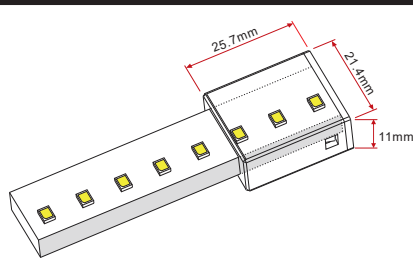

## MOUNTING CLIP DIMENSIONS

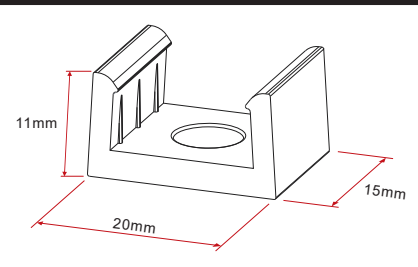

## STRAIGHT JOINER DIMENSIONS

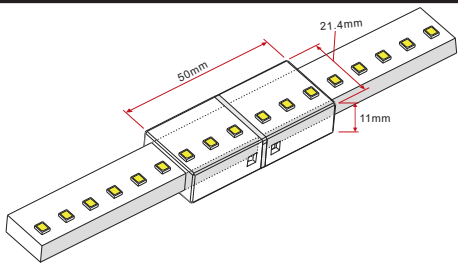

## POWER CORD DIMENSIONS

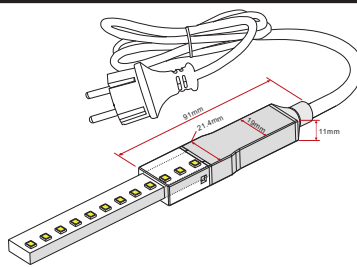

## MOUNTING CLIP DIMENSIONS

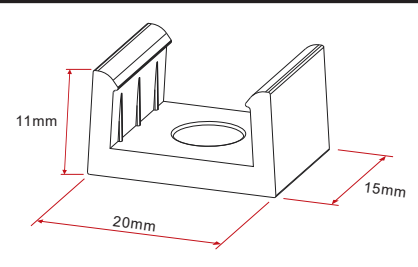

## L JOINER DIMENSIONS

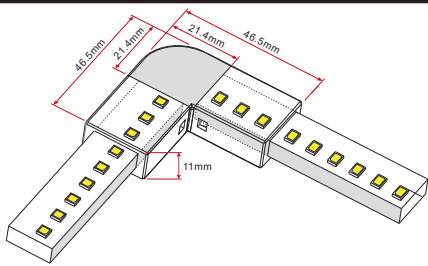

## JOINING CABLE DIMENSIONS

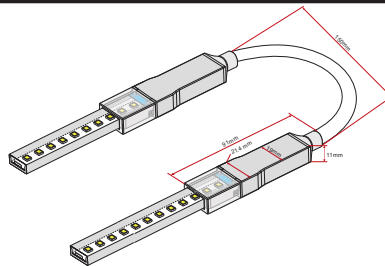

## CHANNEL DIMENSIONS

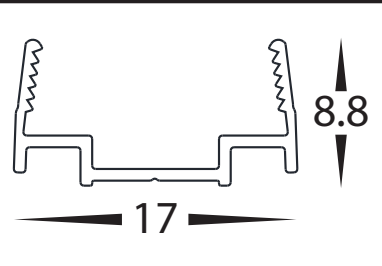

### Please read the instructions carefully before installation.

Guide on accessories are included in these instructions.

After using these instructions keep them stored in a safe location as reference of all further use in the future.

Before installation connect product while uninstalled, If there is any product that is not working correctly, Please contact store where items were purchased from to work out next steps. Do not continue to install the product.

Mounting Clips or Channel must be used when installing to prevent LED Strip from becoming unattached from installation surface.

**WARNING:** This product is very fragile, Any misuse or mishandling will cause product to fail and will void warranty.

# Caution



Correct

- Before making any Cuts, installation, maintenance or connection, make sure the light is disconnected the Electrical supply power Failure to do so could result in serious injury.
- When the light use outdoor, Ground Fault Circuit Interrupter (GFCI) protection should be included on the circuits or electrical outlet.
- Do not submerge the light in water (Fig. 2.1), or use the product in the vicinity of standing water or other liquids.
- Do not install the light closer than 3meters distance from water surface, or closer than the vicinity of standing water or other liquids.
- Do not cover the light as the covering may cause the flexible light to overheat and melt or ignite.
- Do not puncture, shorten, or splice the light (Fig. 2.2), Doing so will result in damaging the internal circuit board.
- Do not bend past the minimum 50mm diameter (Fig. 2.1), Doing so will result in causing electric shock and body injury.
- Do not twist past the minimum 30° angle (Fig. 2.3) Doing so will result in damaging the internal circuit board.
- To extend lifespan of the light, do not operate the light in the temperatures exceeding 60° C (140°F).
- Enviroment temperature not exceed -25° C ~ 45° C (-13°F ~ 113°F) , and LED PIN temperature: maximum 60° C (140°F).

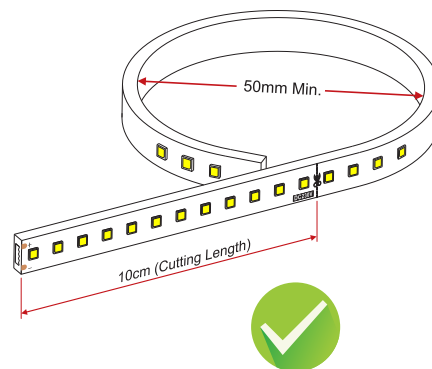

Fig. 2.1

Incorrect

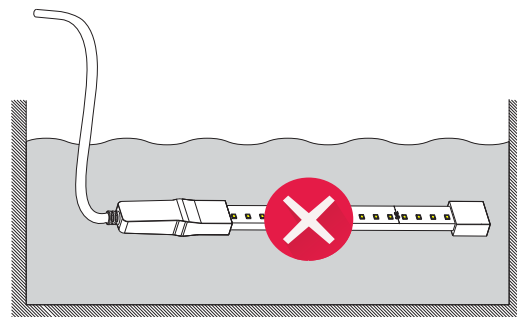

Fig. 2.1

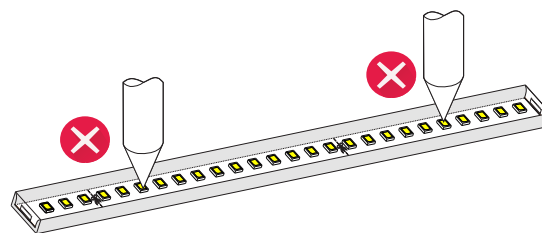

Fig. 2.2

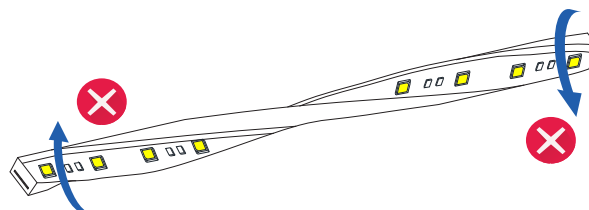

Fig. 2.3

Correct

## Cutting Instructions

- Place the light horizontally when cutting it, and check out the marker line at PCB surface, use only factory-recommended cutting Nippers to cut (Fig. 3.1), if use other cutter caused the internal circuit board.
- The minimum cutting length is 10cm (Fig. 3.2), and can be cut into various length (e.g. 30cm, 50cm, ... 5000cm Maxi.).
- Do not place the light on its side to cut, and doing so will result in damaging the internal circuit board (Fig. 3.3), and  $R < 90^\circ$  or  $R > 90^\circ$  or wave cutting will damage the internal circuit board.
- Cutting must be done at the marker line, and pls do not cut at other place (Fig. 3.4), and doing so will result in damaging the internal circuit board.

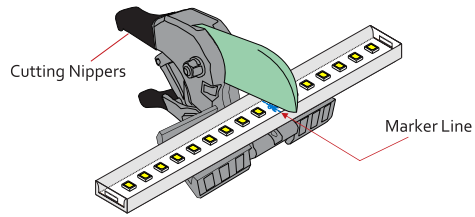

Fig. 3.1

Correct — Cut at the marking line

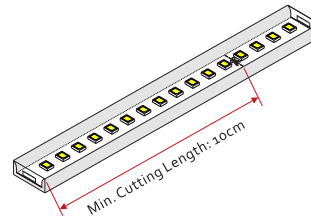

Fig. 3.2

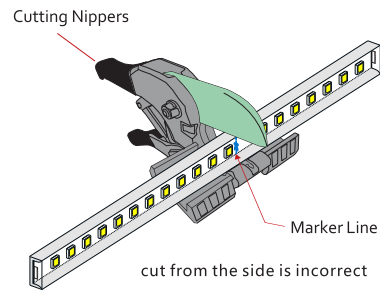
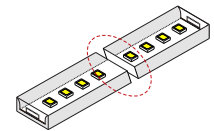
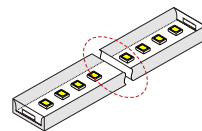

Fig. 3.3

Incorrect



R < 90° Cut incorrect



Wave Cut incorrect

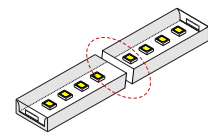

R > 90° Cut incorrect

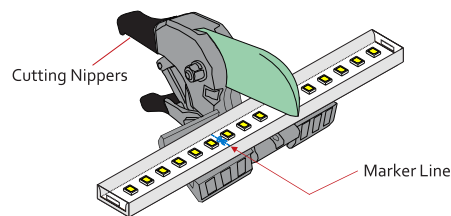

Fig. 3.4

Not cut at the marking line, incorrect



# End Cap

## Assembly Steps

- Fig. 5.1 — Pls doing the assembly according to ① ② ③ ④ steps, and make sure the fixing clip's two fixed ribs are upwards.
- Fig. 5.2 — Inserting the adhesive silicon glue, and make IP65 Waterproof.
- Fig. 5.3 — The complete assembly

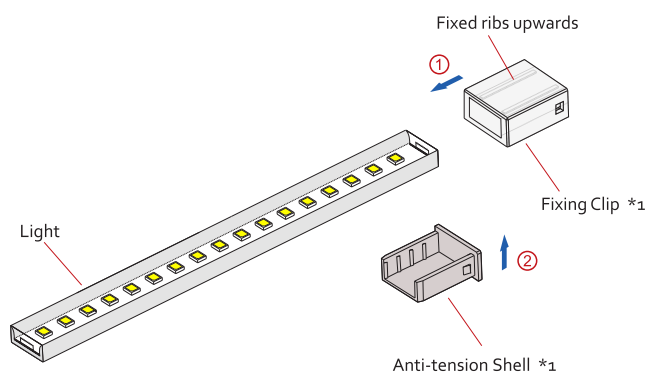

Fig. 5.1

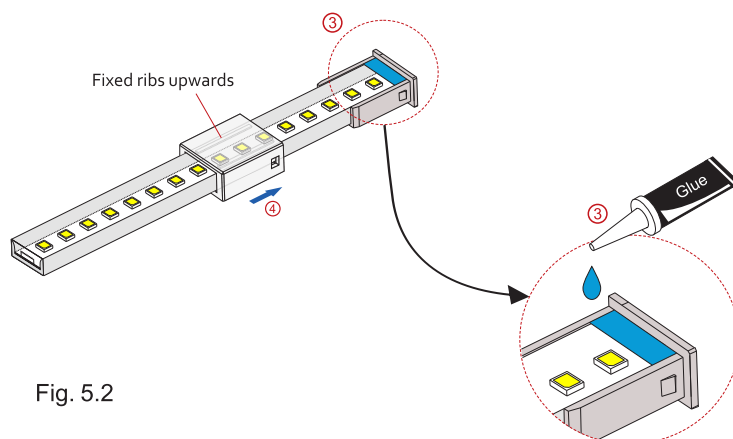

Fig. 5.2

Sectional view

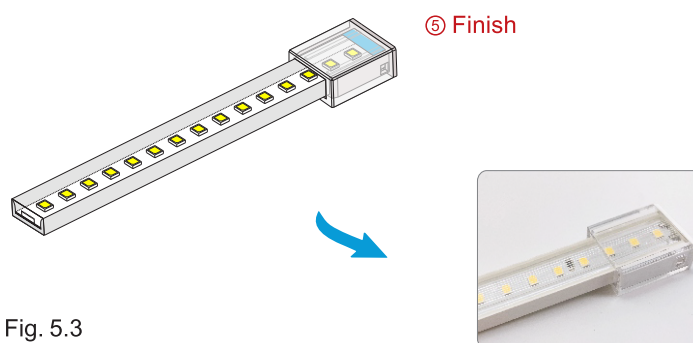

Fig. 5.3

# 240V LED STRIP INSTALLATION INSTRUCTIONS

## Power Cord

## Assembly Caution!

- Fig. 4.1 — Firstly Put the Fixing Clip through the light (As indicated by the blue arrow), and make sure the two fixed ribs are upwards.
- Fig. 4.2 — The 2 Pins must be inserted into the back of the PCB board, to make it energized, and keep the 2-3mm reserved for drop glue.
- Fig. 4.3 — Do not insert the two pins at the surface of the PCB and LED, which will cause the light to short circuit and burn out the entire roll of the light, which cause a fire.
- Fig. 4.4 — Do not insert the one pin into back side of PCB, and insert the another one pin at the surface of the PCB and LED, which will cause the light to short circuit and burn out the entire roll of the light, which may cause a fire.

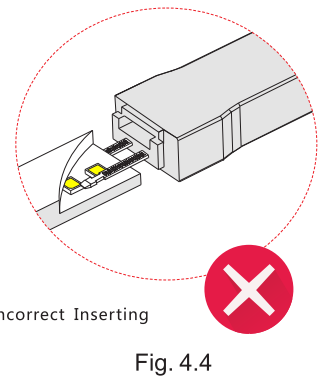
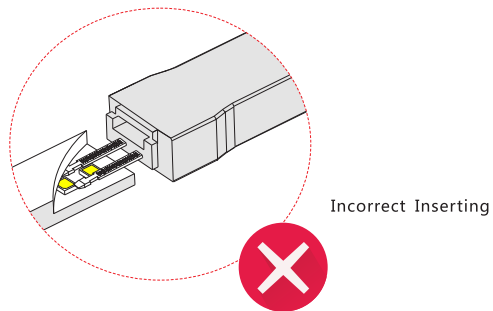
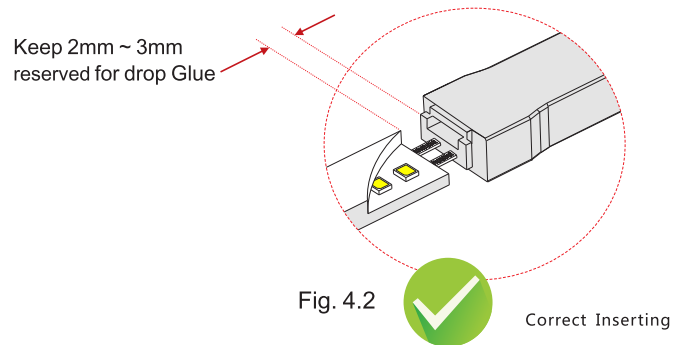
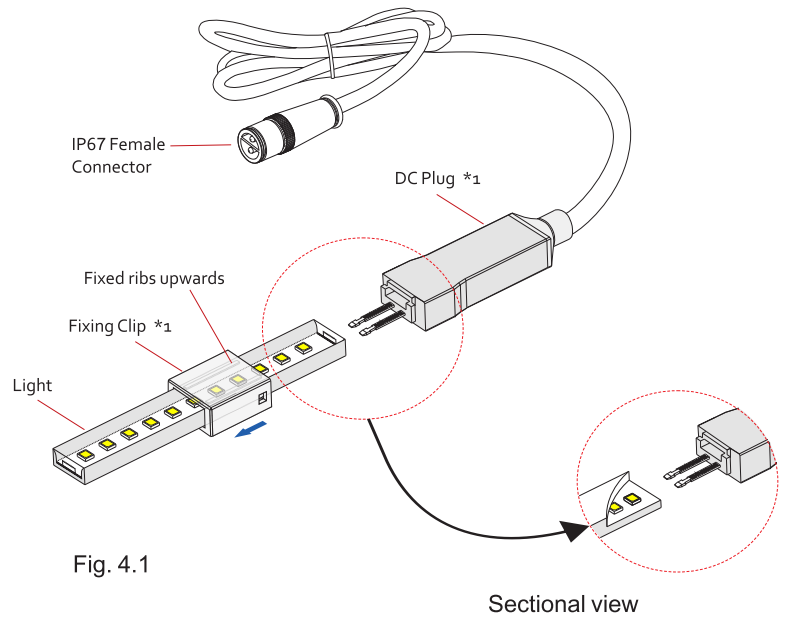

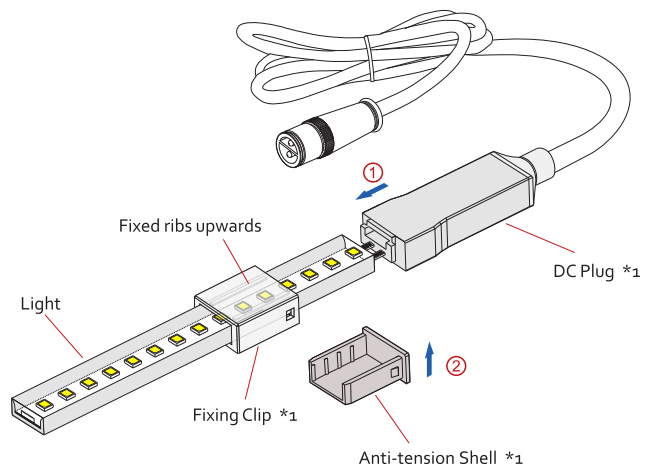

Fig. 4.5

- Fig. 4.5 — Pls doing the assembly according to ① ② ③ ④ steps, and make sure the fixing clip's two fixed ribs are upwards.
- Fig. 4.6 — Inserting the adhesive silicon glue, and make IP65 Waterproof.
- Fig. 4.7 — The complete assembly

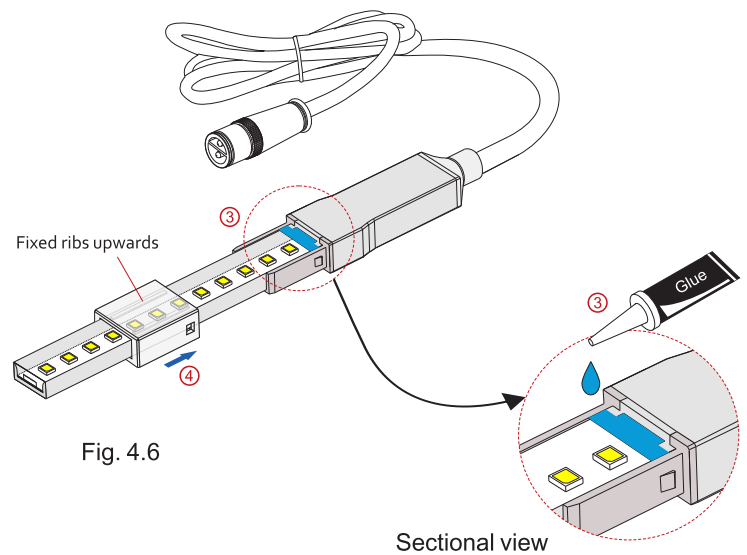

Fig. 4.6

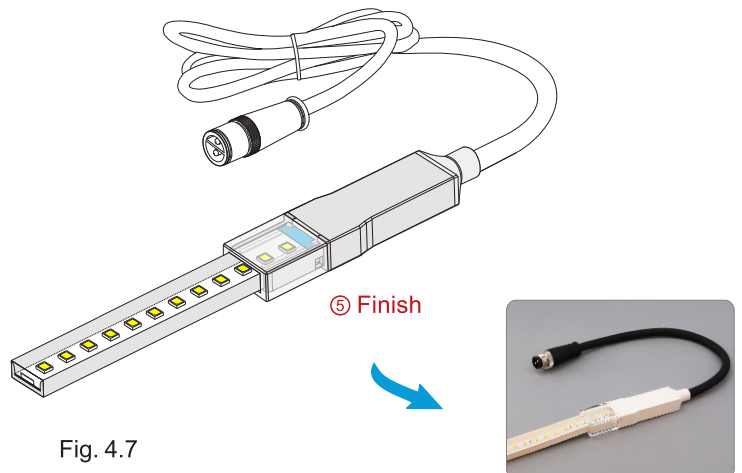

Fig. 4.7

## L-Type Connector Assembly Caution!

- Fig. 7.1 — Firstly Put the two Fixing Clips through the light (As indicated by the blue arrow), and make sure the two fixed ribs are upwards.
- Fig. 7.2 — The 4 Pins must be inserted into the back of the PCB board, to make it energized, and keep the 2-3mm reserved for drop glue.
- Fig. 7.3 — Do not insert the 4 pins at the surface of the PCB and LED, which will cause the light to short circuit and burn out the entire roll of the light, which cause a fire.
- Fig. 7.4 — Do not insert the 2 pin into back side of PCB, and insert the another 2 pin at the surface of the PCB and LED, which will cause the light to short circuit and burn out the entire roll of the light, which may cause a fire.

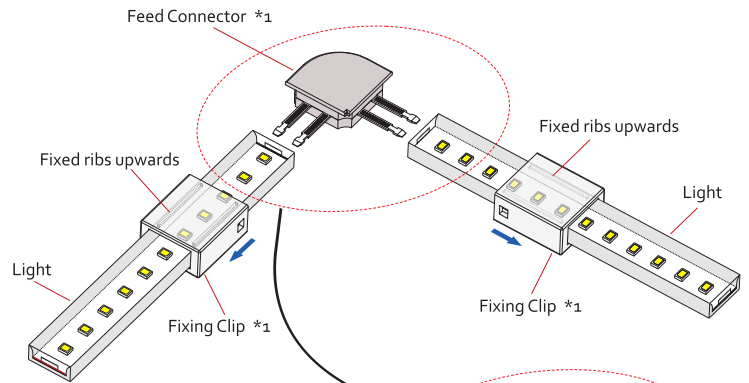
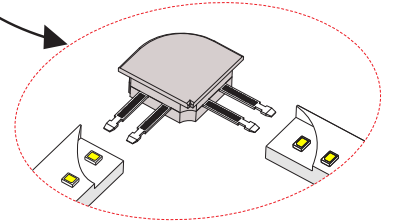

Fig. 7.1



Sectional view

Keep 2mm ~ 3mm reserved for drop Glue

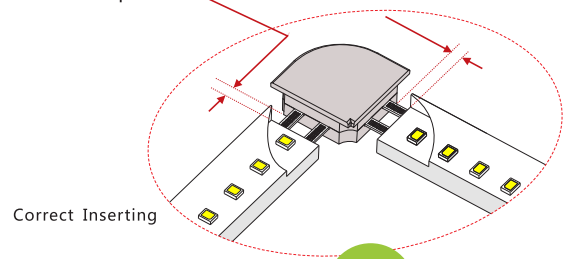

Fig. 7.2

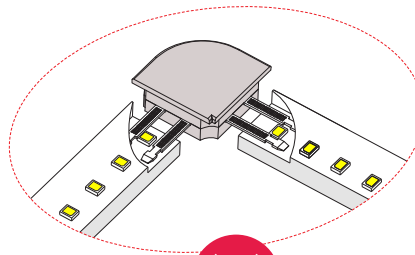

Fig. 7.3



Incorrect Inserting

Incorrect Inserting

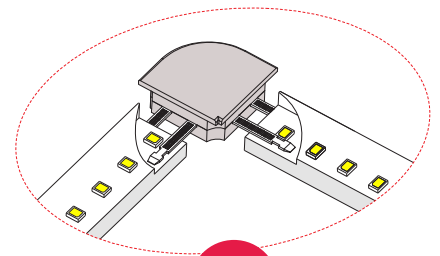

Fig. 7.4



# L-Type Connector Assembly Steps

- Fig. 7.5 — Pls doing the assembly according to ① ② ③ ④ ⑤ ⑥ ⑦ steps, and make sure the fixing clip's two fixed ribs are upwards.
- Fig. 7.6 — Inserting the adhesive silicon glue, and make IP65 Waterproof.
- Fig. 7.7 — The complete assembly

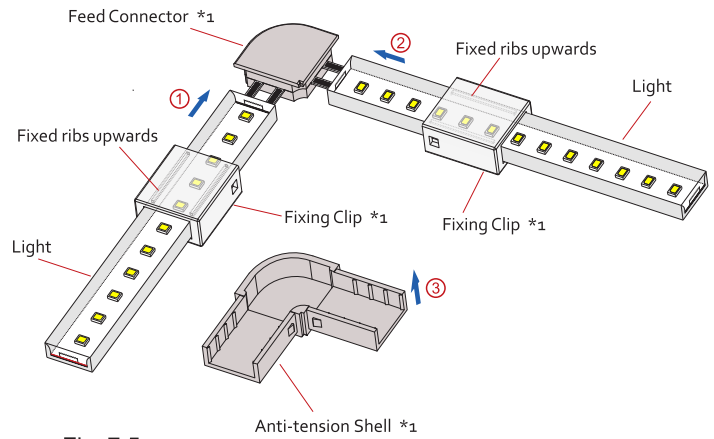

Fig. 7.5

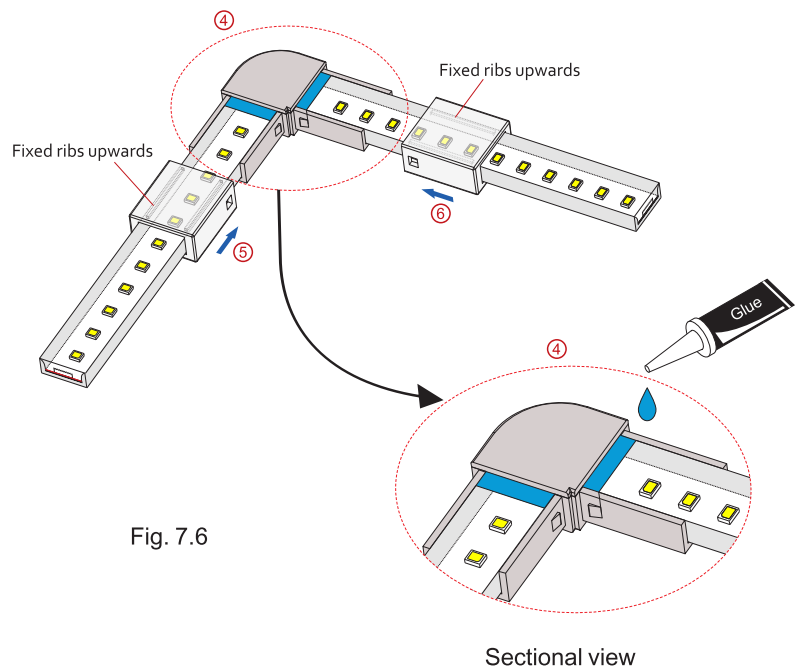

Fig. 7.6

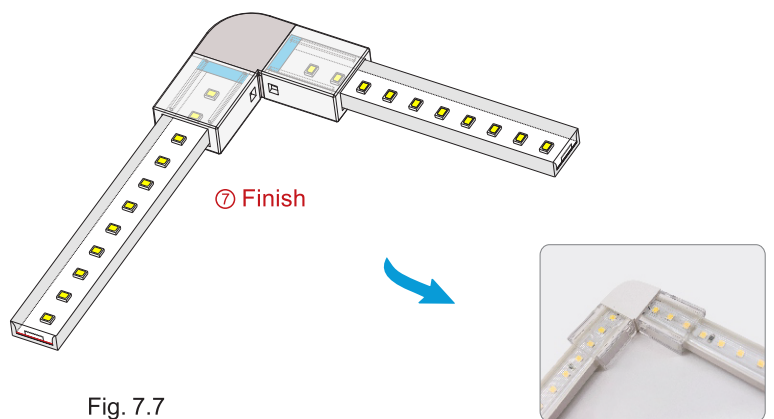

Fig. 7.7

## Docking Connector Assembly Steps

- Fig. 6.5 — Pls doing the assembly according to ① ② ③ ④ ⑤ ⑥ ⑦ steps, and make sure the fixing clip's two fixed ribs are upwards.
- Fig. 6.6 — Inserting the adhesive silicon glue, and make IP65 Waterproof.
- Fig. 6.7 — The complete assembly

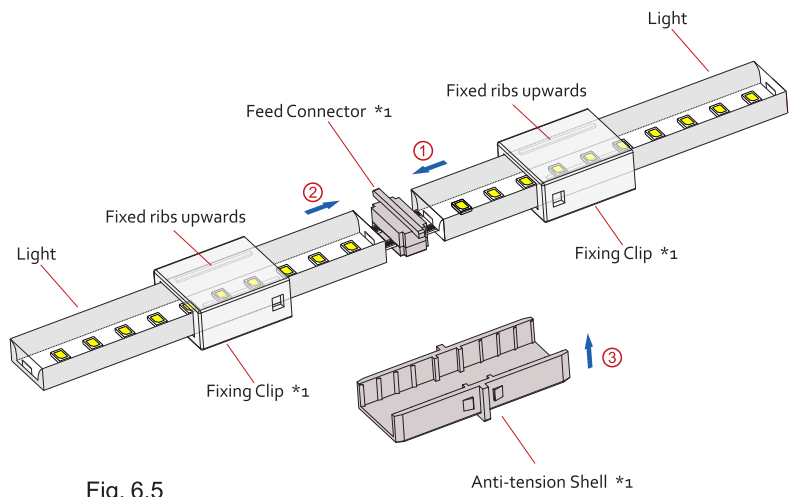

Fig. 6.5

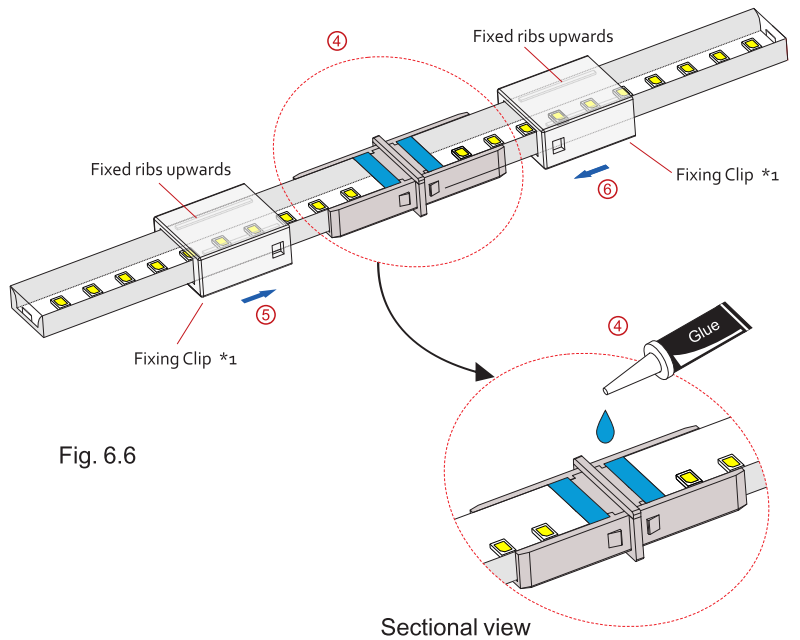

Fig. 6.6

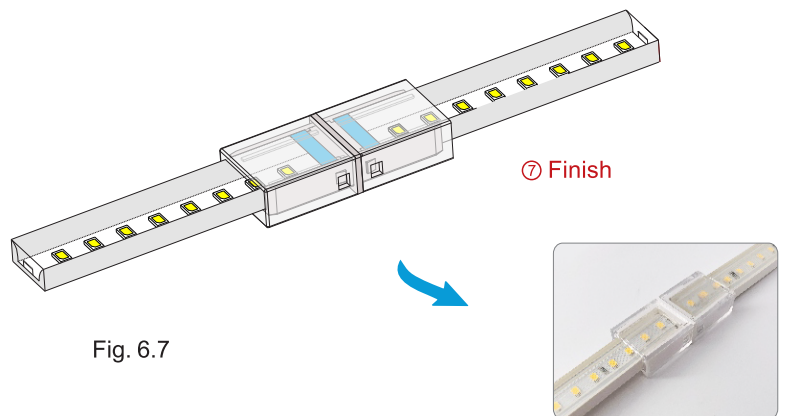

Fig. 6.7

# Jumper Connector Assembly Steps

- Fig. 8.5 — Pls doing the assembly according to ① ② ③ ④ ⑤ ⑥ ⑦ ⑧ steps, and make sure the fixing clip's two fixed ribs are upwards.
- Fig. 8.6 — Inserting the adhesive silicon glue, and make IP65 Waterproof.
- Fig. 8.7 — The complete assembly

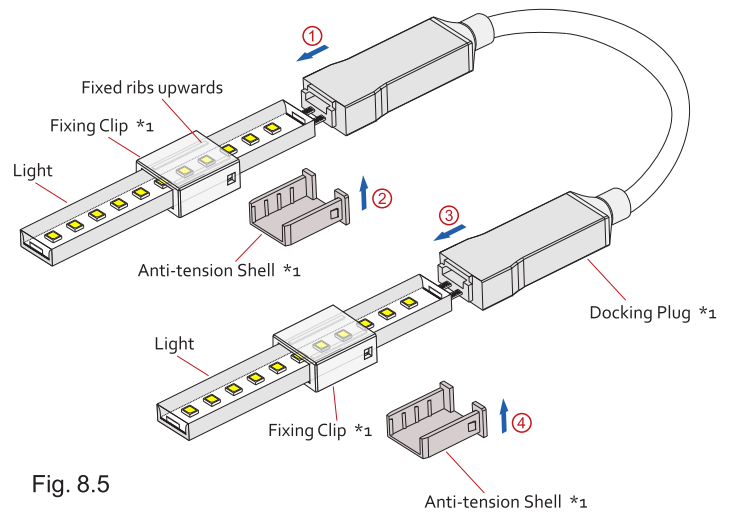

Fig. 8.5

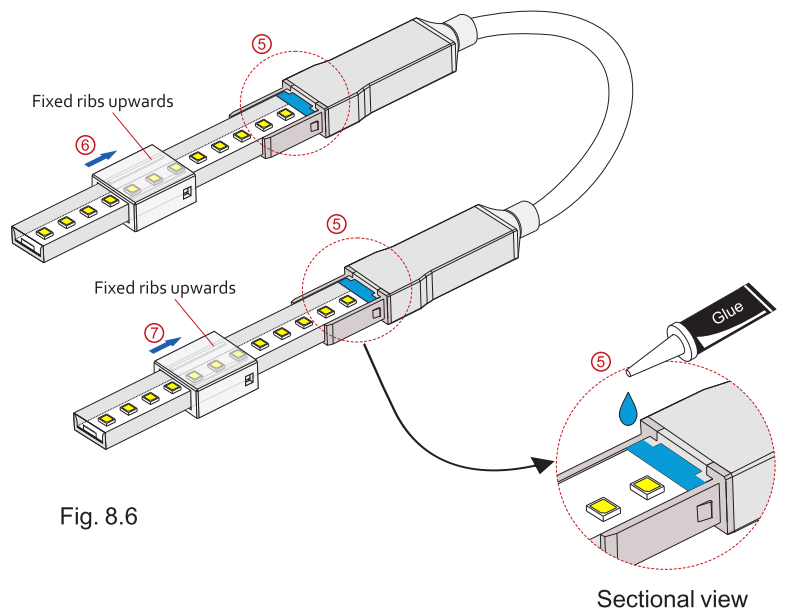

Fig. 8.6

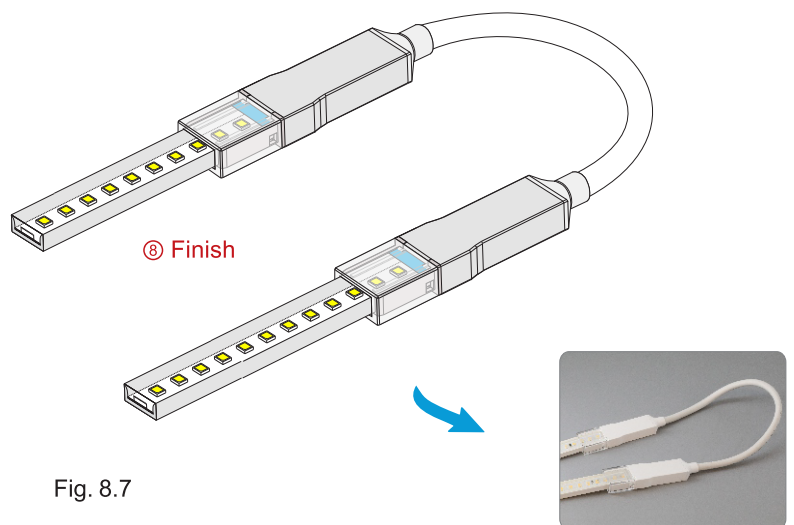

Fig. 8.7