

Pelase Antique Brass

Wall or Step Light

Name	Pelase
Material	Solid Brass
Colour	Antique Brass
IP Rating	IP65
Colour Temp	<div>3000k</div> <div>4000k</div> <div>5500k</div>
IK Rating	IK10
Installation Type	Wall - Surface Mounted
Diffuser Type	Frosted Polycarbonate
Lamp Base	Built in LED
Max Wattage	3w
Protection Class	240v = 1 (Earth Required) 12v DC = 3 (No Earth Required)
Lamp Expectancy	<30,000hrs
CRI	CRI>80
Dimmable	Yes
Warranty	3 Years Replacement



Mounting Base

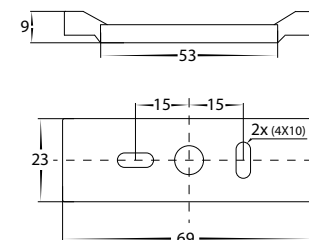

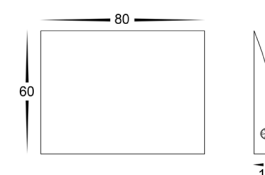

Dimensions for HV3291

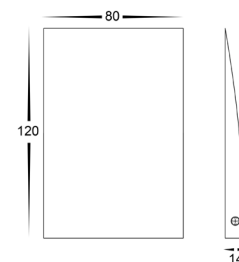

Dimensions for HV3292



Product Ordering

Image	Part Number	Colour Temp	Lumens	Input Voltage	Beam Angle	Included LED	Barcode
	HV3291T-AB-12V	<div>3000k</div> <div>4000k</div> <div>5500k</div>	240lm 245lm 250lm	12V DC	120°	TRI Colour Built in 3w LED	9350418036995
	HV3292T-AB-12V			12V DC			9350418037022

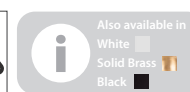
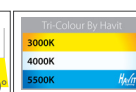



Warranty
Terms & Conditions



Website



Optional Havit Compatible Accessories

Image	Part Number	Description
	12v DC LED Drivers	See Catalogue or Website for full range of 12v DC LED Drivers
	HV9911	Small IP67 Weatherproof Connector
	HV9912	Medium IP67 Weatherproof Connector
	HV9913	Large IP67 Weatherproof Connector

Pelase Black

Wall or Step Light

Name	Pelase
Material	Solid Brass
Colour	Poly Powder Coated Black
IP Rating	IP65
Colour Temp	<div>3000k</div> <div>4000k</div> <div>5500k</div>
IK Rating	IK10
Installation Type	Wall - Surface Mounted
Diffuser Type	Frosted Polycarbonate
Lamp Base	Built in LED
Max Wattage	3w
Protection Class	240v = 1 (Earth Required) 12v DC = 3 (No Earth Required)
Lamp Expectancy	<30,000hrs
CRI	CRI>80
Dimmable	Yes
Warranty	3 Years Replacement



Mounting Base

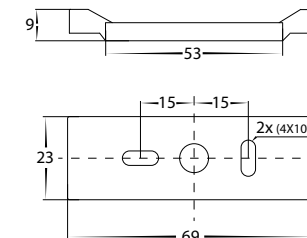

Dimensions for HV3291

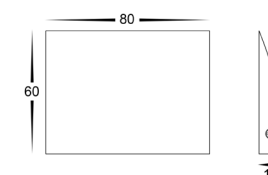

Dimensions for HV3292

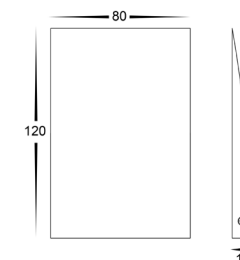

Product Ordering

Image	Part Number	Colour Temp	Lumens	Input Voltage	Beam Angle	Included LED	Barcode
	HV3291T-BLK-12V	<div>3000k</div> <div>4000k</div> <div>5500k</div>	240lm 245lm 250lm	12V DC	120°	TRI Colour Built in 3w LED	9350418037015
	HV3292T-BLK-12V			12V DC			9350418037046

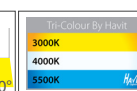

Warranty
Terms & Conditions



Website



Optional Havit Compatible Accessories

Image	Part Number	Description
	12v DC LED Drivers	See Catalogue or Website for full range of 12v DC LED Drivers
	HV9911	Small IP67 Weatherproof Connector
	HV9912	Medium IP67 Weatherproof Connector
	HV9913	Large IP67 Weatherproof Connector

Pelase Solid Brass

Wall or Step Light

Name	Pelase
Material	Solid Brass
Colour	Brass
IP Rating	IP65
Colour Temp	<div>3000k</div> <div>4000k</div> <div>5500k</div>
IK Rating	IK10
Installation Type	Wall - Surface Mounted
Diffuser Type	Frosted Polycarbonate
Lamp Base	Built in LED
Max Wattage	3w
Protection Class	240v = 1 (Earth Required) 12v DC = 3 (No Earth Required)
Lamp Expectancy	<30,000hrs
CRI	CRI>80
Dimmable	Yes
Warranty	3 Years Replacement



Mounting Base

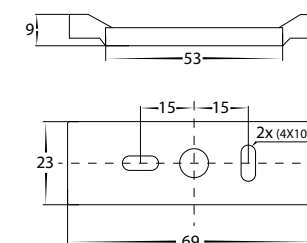

Dimensions for HV3291

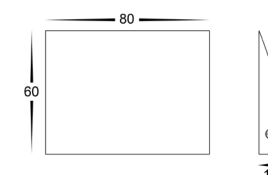

Dimensions for HV3292

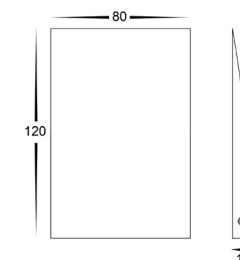

Product Ordering

Image	Part Number	Colour Temp	Lumens	Input Voltage	Beam Angle	Included LED	Barcode
	HV3291T-BR-12V	3000k 4000k 5500k	240lm 245lm 250lm	12V DC	120°	TRI Colour Built in 3w LED	9350418037008
	HV3292T-BR-12V			12V DC			9350418037039



Optional Havit Compatible Accessories

Image	Part Number	Description
	12v DC LED Drivers	See Catalogue or Website for full range of 12v DC LED Drivers
	HV9911	Small IP67 Weatherproof Connector
	HV9912	Medium IP67 Weatherproof Connector
	HV9913	Large IP67 Weatherproof Connector

Pelase White

Wall or Step Light

Name	Pelase
Material	Solid Brass
Colour	Poly Powder Coated White
IP Rating	IP65
Colour Temp	<div>3000k</div> <div>4000k</div> <div>5500k</div>
IK Rating	IK10
Installation Type	Wall - Surface Mounted
Diffuser Type	Frosted Polycarbonate
Lamp Base	Built in LED
Max Wattage	3w
Protection Class	240v = 1 (Earth Required) 12v DC = 3 (No Earth Required)
Lamp Expectancy	<30,000hrs
CRI	CRI>80
Dimmable	Yes - Triac / Phase Cut
Warranty	3 Years Replacement



Mounting Base

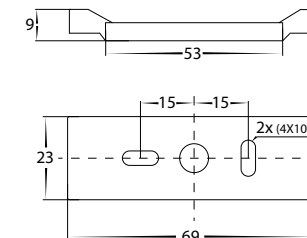

Dimensions for HV3291

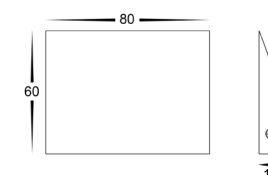

Dimensions for HV3292

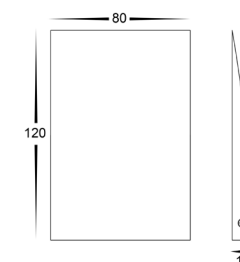

Product Ordering

Image	Part Number	Colour Temp	Lumens	Input Voltage	Beam Angle	Included LED	Barcode
	HV3291T-WHT-12V	<div>3000k</div> <div>4000k</div> <div>5500k</div>	240lm	12V DC	120°	TRI Colour Built in 3w LED	9350418038425
	HV3292T-WHT-12V		245lm 250lm	12V DC			9350418038432

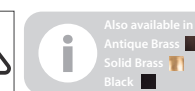
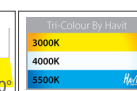

Warranty
Terms & Conditions



Website



Optional Havit Compatible Accessories

Image	Part Number	Description
	12v DC LED Drivers	See Catalogue or Website for full range of 12v DC LED Drivers
	HV9911	Small IP67 Weatherproof Connector
	HV9912	Medium IP67 Weatherproof Connector
	HV9913	Large IP67 Weatherproof Connector