

D Series Knob Panel



D61

1. Technical Specs:

D61 Dimming Knob Panel

Input Voltage: 12-24Vdc

Output Voltage: 12-24Vdc

Max Current Load: 6A×1CH + 0-10V×1CH

Max Output Power: 72W/144W (12V/24V)

Dimming Range: 5-100%

Working Temp.: -30°C~55°C

Package Size: L106×W106×H60(mm)

Weight(G.W.): 220g

2. Product Size:

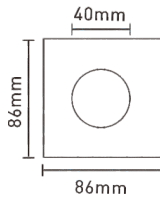

3. Installation Instruction:

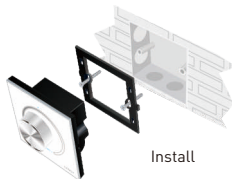

Install

4. Knob Function:



Short press: On/Off.

Long press: Adjust brightness.

Spin: Adjust brightness.

* When powered off, long press the knob for 5 seconds to turn on (off) the key tone.

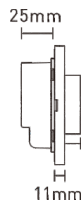

5. Terminals:

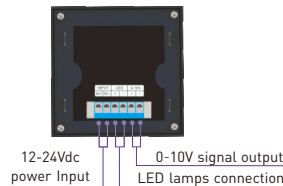

6. Wiring Diagram :

Connect with 12V strip. Max 72W; Connect with 24V strip. Max 144W

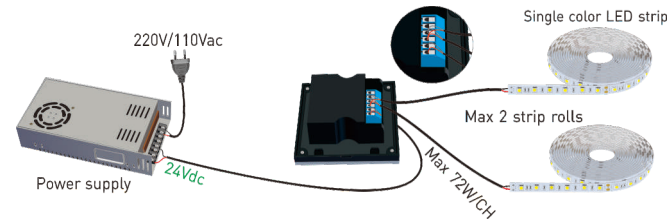

Providing 0-10V signal output terminal:

