

HV3683T-WHT, HV3683T-BLK, HV3684T-WHT, HV3684T-BLK - Revo Double Adjustable Spot Light/ Installation Instructions

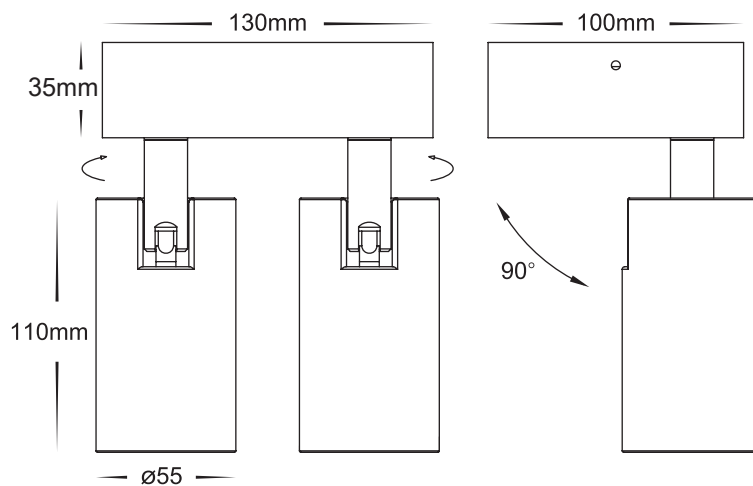

Model No.	Voltage	Power	CCT	Material	IP Grade
HV3683T-BLK	AC240V	2*9W	Tri Colour	AL	IP65
HV3683T-WHT	AC240V	2*9W	Tri Colour	AL	IP65
HV3684T-BLK	AC240V	2*9W	Tri Colour	AL	IP65
HV3684T-WHT	AC240V	2*9W	Tri Colour	AL	IP65



Symbols



Dust Tight, zero ingress of dust permitted.
Protected against jets of water.
Limited ingress permitted.



The WEEE symbol, indicating separate collection for WEEE-Waste of electrical and electronic equipment, consists of the cross-out wheeled bin.



class of protection (SELV).



All the material used is up to standard.



LED light source.

SAFETY INSTRUCTIONS

Read these instructions carefully before commencing installation and retain for future reference. The luminaire should be installed by a licensed electrician and in accordance with local regulations. Make sure that the power is off before installation or maintenance. Install as described below.

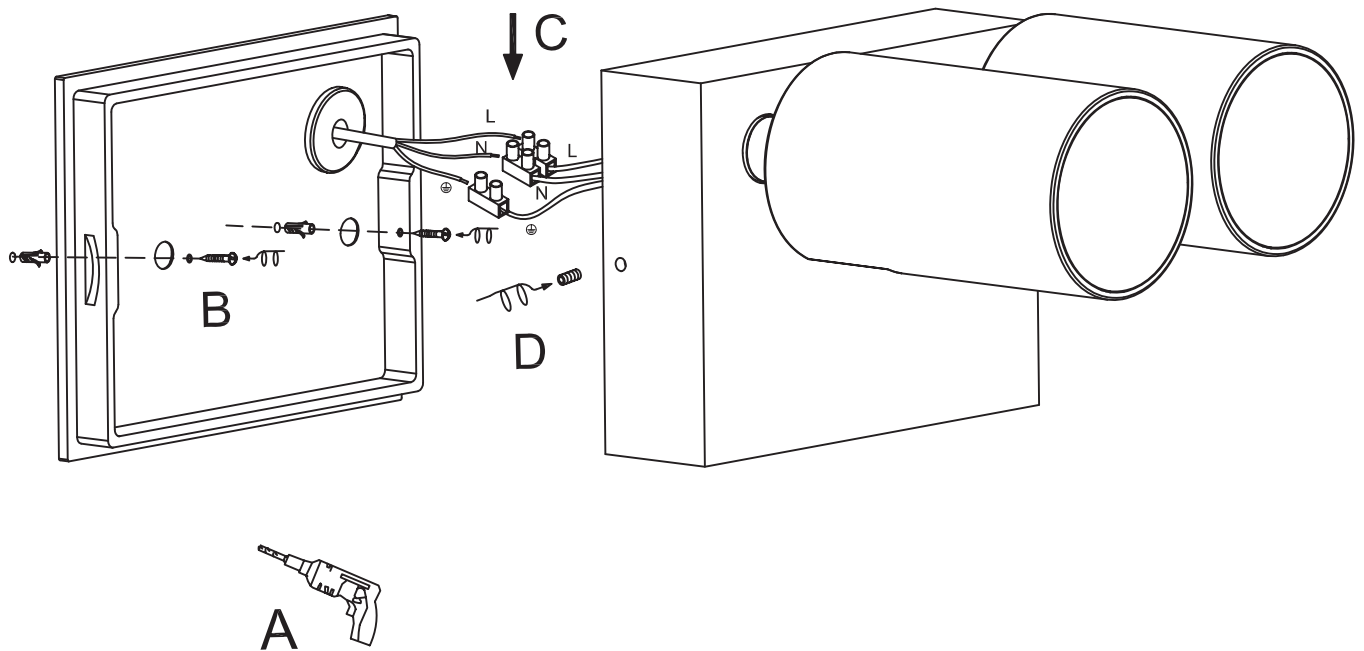

1. This LED luminaire should be installed by a licensed electrician only and in accordance with all local regulations.
2. Do not connect luminaire to live power source.
3. Take care during installation, incorrect connection may damage the luminaire resulting in reduced lifespan.
4. Ensure all wall retaining screw heads / mains feed entry are covered in silicon sealant if possible.
5. Clean the appliance with a soft cloth and a standard PH neutral detergent.
6. Misuse of, or changes to the appliance shall nullify the guarantee.
7. The manufacturer is free to change the design, specifications and instructions for assembly.
8. Connect the LED luminaire to the converter before the converter is connected to the power source.