

Taper Wall Wedge Light Installation Instructions



Product Specifications

| | | | | | | | | |
|---------------|----------------------|-------------|------------|------------|---------------------|---------------|-------------|-------------|
| Model No. | HV3608W-BLK | HV3608C-BLK | HV3608W-CP | HV3608C-CP | HV3608W-SS316 | HV3608C-SS316 | HV3608W-WHT | HV3608C-WHT |
| Name | Taper | | | | | | | |
| Material | 316 Stainless Steel | | Copper | | 316 Stainless Steel | | | |
| Colour | Black | | Copper | | Stainless Steel | | White | |
| IP Rating | IP44 | | | | | | | |
| Input Voltage | 12v DC | | | | | | | |
| Lamp Base | G4 | | | | | | | |
| Lamp Wattage | 1x 1.5w | | | | | | | |
| Colour Temp | 3000k | 5500k | 3000k | 5500k | 3000k | 5500k | 3000k | 5500k |
| Lumens | 90lm | 110lm | 90lm | 110lm | 90lm | 110lm | 90lm | 110lm |
| CRI | > 80 | | | | | | | |
| Wiring | Parallel | | | | | | | |
| Dimmable | No | | | | | | | |
| Warranty | 2 Years Replacement* | | | | | | | |

Important Safety Issues:

- This product must be installed by a qualified electrician according to AS/NZS 3000.
- Ensure all electrical mains are disconnected before any installation.
- Do not exceed maximum wattage restrictions for globes: 240V GU10 = 35w / 12V MR16 = 20w
- Modification of this product will void any warranty.
- Havit Lighting does not take responsibility for wrong installation, incorrect use, or use of installation material that does not belong to the system.
- When installing low voltage fittings, Voltage to fitting must be within +or- 5% of voltage required and cannot be installed more than 25m from LED Driver, if not within this allowance warranty will be voided.
- Aluminium and 304SS fittings must not be installed within 2km of any salt water environments.
- When installing copper fittings, gloves must be worn to avoid any oils transferring to fitting.
- All 316 stainless steel fittings must have regular cleaning maintenance to avoid any tea staining from forming on fitting. (Warranty does not cover Tea Staining)
- All o-rings and seals must be in place correctly to maintain warranty.
- These instructions may be updated at any time due to product improvements, Please visit website for most current installation instructions.

Dimensions

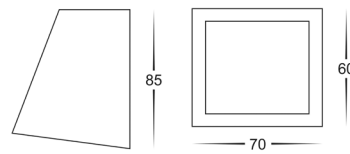

Mounting Base Diagram

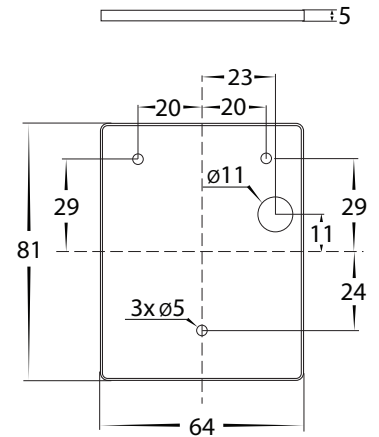

Steps for Installation:

- Make sure that the electrical circuit is free of voltage (master switch off)
- Remove the screws from side of fitting and remove cover and set aside
- Install base plate to wall in desired location
- Using an appropriate 12v LED Driver - DO NOT CONNECT LIGHT FITTING DIRECTLY TO 240V
- Connect the cable - If more than one fitting installed, wiring must be done in parallel.
- Insert globe by aligning the 2 pins with the 2 holes on the lampholder and push gently
- Reattach cover to base plate making sure screws are tight to avoid water penetration
- Apply silicon around edge of fitting to prevent any water from getting inside to electrical connections.
- All connections must be carried out carefully, inspect all contacts before switching back on the electric circuit.

Steps for Changing Globe:

- Remove cover from fitting by removing the 2 screws and removing cover
- Remove globe by holding the sides and pulling gently.
- Re-insert the appropriate globe by aligning the 2 pins with the 2 holes on the lampholder and push gently (Make sure not to exceed max wattage, see product label for correct info)
- Reattach cover to base plate making sure screws are tight to avoid water penetration
- Apply silicon around edge of fitting to prevent any water from getting inside to electrical connections.

Must be installed by a licensed electrician

Contact Details:

143 Beauchamp Road
Matraville NSW 2036
Australia

Tel: 02 9381 8300
Fax: 02 9666 8881
Email: sales@havit.com.au
Web: www.havit.com.au

Warranty Terms & Conditions*



Additional Information



HV3608-BLK



HV3608-CP



HV3608-SS316



HV3608-WHT