

### CHAM-DIM-DALI-1C

May 19, 2022 12:02 pm

Order Code	Product Code	Description
20132	CHAM-DIM-DALI-1C	DALI push dimmer

The CHAM-DIM-DALI-1C series DALI push dimmer is a highly reliable product with excellent performance. It can be used in PUSH DIMMER mode or addressed to suit a DALI system.

### Specifications

Input Voltage:	12-24VDC	Load Current:	1x8A	Max Load Power:	1x(96-192W)
DALI voltage:	Typical-16V, Maximum-22.5V	DALI current:	<=2mA	Working Temp:	-20° -+50°
Load Type:	0.04-0.1W LED				

#### DALI dimming parameters (factory default)

Minimum dimming value:	0.1%	Maximum dimming value:	100%
Fade Time:	0	Fade Time:	7

### Function features:

- Getting standard DALI signal control interface and perfect compatibility. DALI push dimmer can integrate into any other companies DALI system.
- DALI address can be automatically assigned via the DALI master controller or it can be manually addressed. With this flexibility, it greatly reduces the difficulty of project installations.
- DALI address is very intuitive by the digital display located on the front of the controller. There is no need to test each address one by one to determine the correct one. This saves a lot of time in project installations.
- Manual settings are made easy by the digital display and micro push buttons located underneath the display.
- DALI push dimmer only gets standard DALI dimming functions but it's also compatible with PUSH DIMMER functions. At the same signal port (D1 and D2) it can import DALI signal to dim the lights or can be used in (Pd) mode through a 200-240VAC voltage input switch (momentary). This can be used in traditional wall mounted switch plates to control LED constant voltage lighting systems.
- The CHAM-DIM-DALI-1C can be used in conjunction with the power data repeater (Chameleon 05) to extend its output.

### Dimensions:

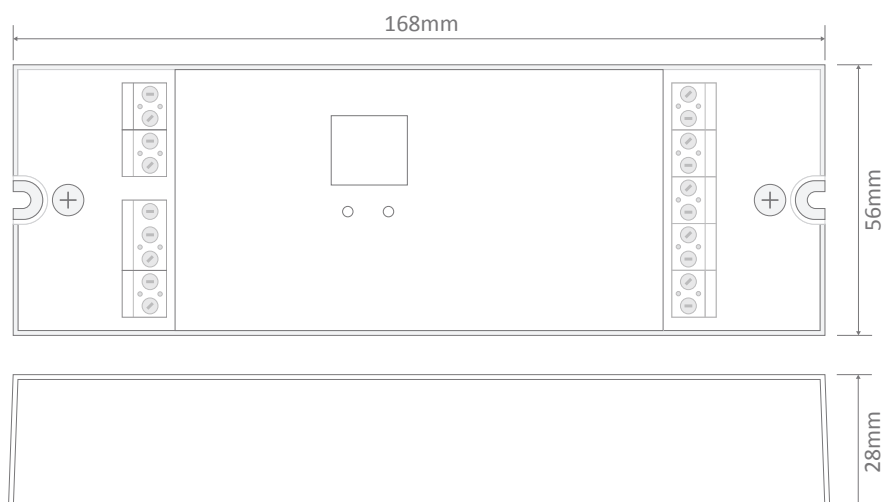

**Note:** -The lamp must be installed by professional electrician  
-Ensure the power supply is switched off before fitting this product

-Do not touch the lamp when in use  
-Keep away from hot steam and corrosive gas

### Instructions for usage:

1. **Connection** for CHAMELEON 23 DALI push dimmer. Please view below information.

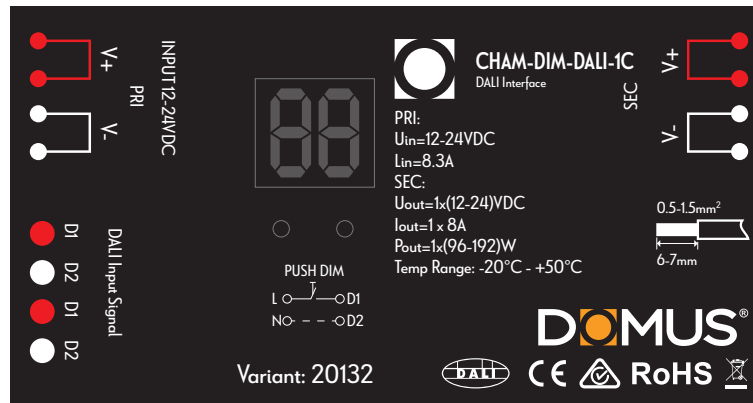

### 2. Setting address

- Manual setting (addressing) If you don't want to assign an address automatically via the DALI master controller please manual setting function as below. Please make sure you have the correct power supply connected to the CHAM-DIM-DALI-1C interface unit. Once you see the RED colour LCD display illuminated press any button (B1 or 82) for 2 seconds. At this stage "88" will flash on the digital display. This is now in the mode to set the address. Using (B1) or (82) please set the address number as required. For example to set the address to "858" press (B1) to the number 5 and then press (82) to the number 8. Please repeat this method for any other interface units. After the address has been entered press any or the buttons (B1) or (82) for 2 seconds and at this stage the display will stop flashing. The entered address is now saved successfully and even if power is lost the address will remain in its memory.

- Assigning an address automatically via DALI master controller**

The address of the DALI push dimmer can not only be set manually but it can also receive an assigned address command by the DALI master controller. This type of addressing is the same as all other companies DALI products. For detailed operations please review the manual from the supplier of the DALI master controller. Each address will be shown on the digital display.

### 3. Operation under DALI dimming mode

Under this mode the DALI device is just a standard DALI LED dimmer. It can be connected to any DALI master controller. All dimming functions will be controlled via the DALI master controller.

### 4. Operating as a single 1-button push dimmer

Under this mode the DALI device can be isolated from the DALI system and can be used in stand alone mode. It can be operated as an independent dimmer controller through a momentary (normally open) push button switch with a L-LINE in voltage between (200-240VAC). It can also be connected to all other DALI input ports located on the device. By pressing the button (momentary switch) short press (less than 0.5 seconds) will turn of the LEDs "ON" or "OFF". By pressing the button (momentary switch) longer press (greater than 1.5 seconds) will increase or decrease the brightness levels of the LED lighting.

### 5. Switching of 2 modes

The DALI device can be switched many times between "DALI DIMMER" mode and "PUSH DIMMER" mode but cannot be used at the same time. Please select between either selected mode.

## Installation Manual

### 6. Wiring

- Wiring with DALI dimmer (Automation)

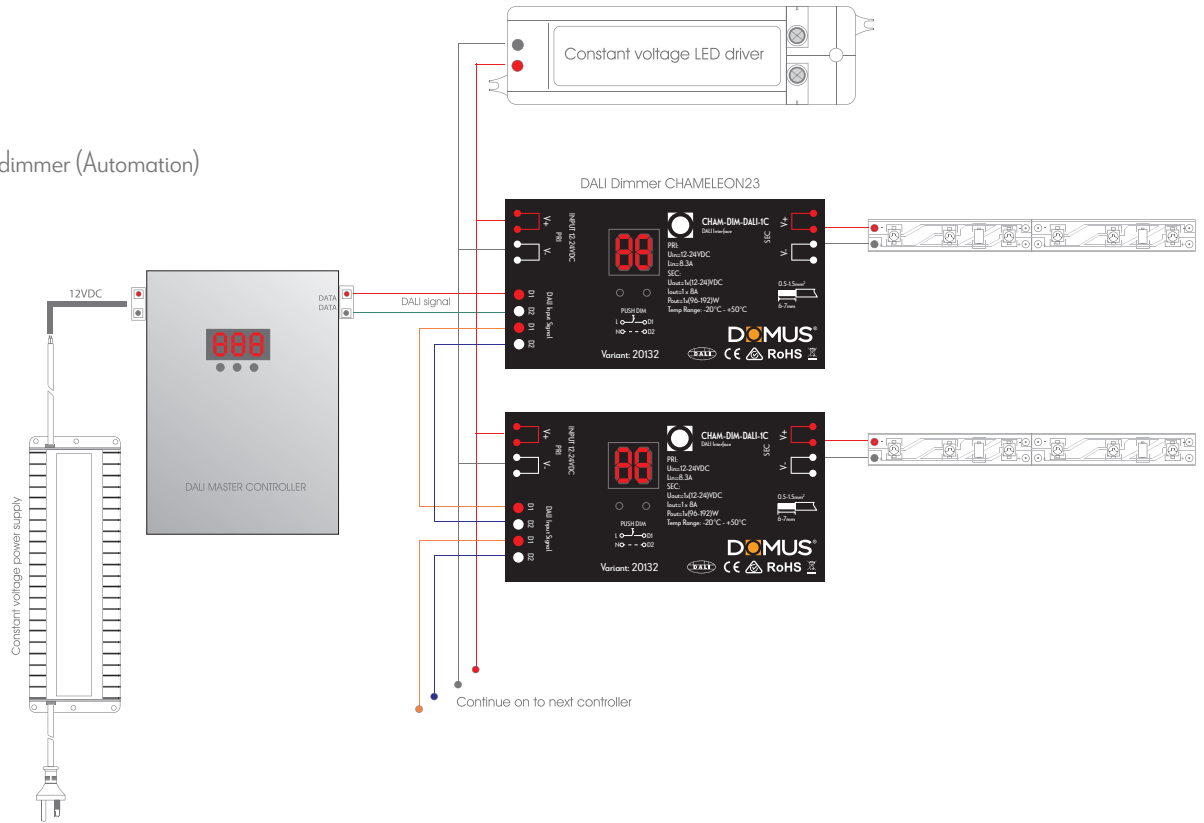

- Wiring with PUSH dimmer function

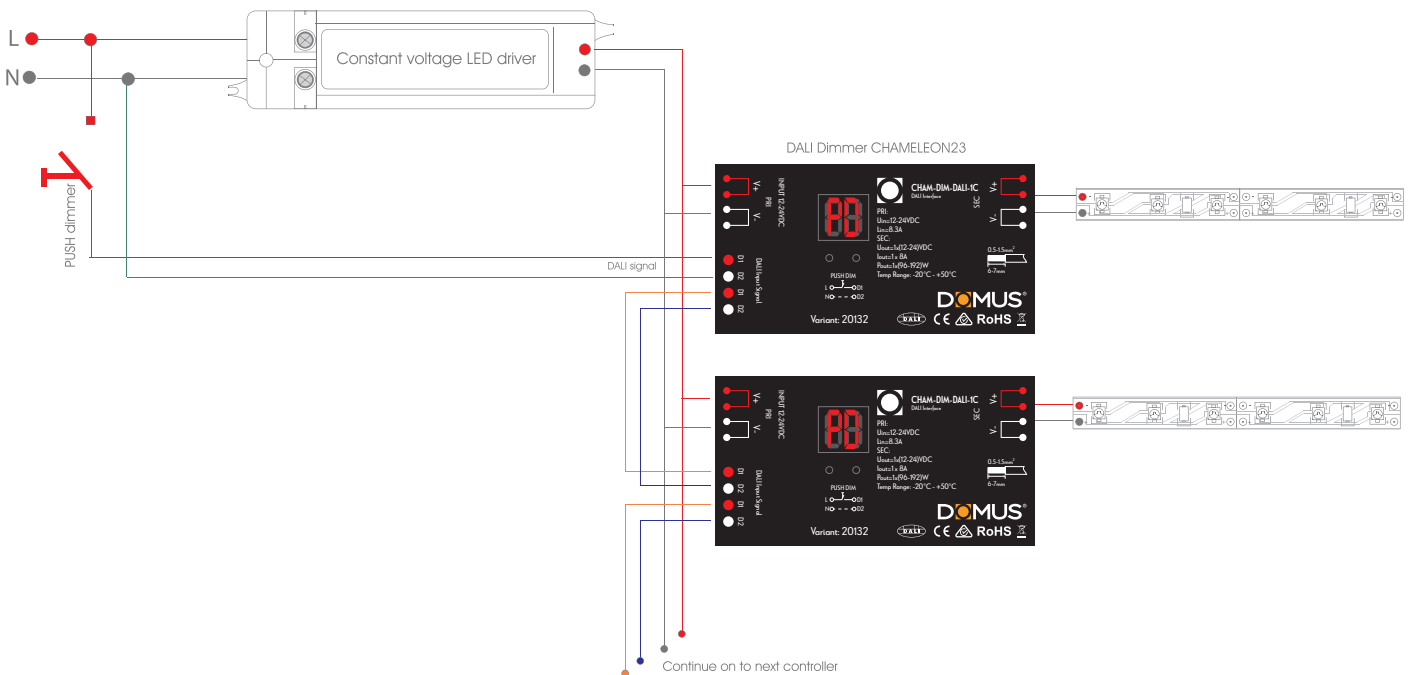

**Note:** -The lamp must be installed by professional electrician  
 -Ensure the power supply is switched off before fitting this product

-Do not touch the lamp when in use  
 -Keep away from hot steam and corrosive gas