



MULTI FAN CONTROLLER FOR AC CEILING FAN

Model No: 99777

Congratulation on the purchase of your new Brilliant Multi Fan Controller for AC ceiling fan. Before first using, it is most important that you read and follow these instructions, even if you feel you are quite familiar with this type of product. Keep this document handy for future reference.

THIS FITTING MUST BE INSTALLED BY A QUALIFIED ELECTRICAL CONTRACTOR in accordance with the latest AS/NZS 3000 and relevant amendments

FOR YOUR SAFETY

- To prevent electrical shock, please ensure that POWER is DISCONNECTED before installation.
- Do not install in a position where the fitting can be easily accessed by children or the infirm.
- Do not touch any parts of the wire terminal with bare hands while it is 'ON'.
- Do not perform modification to the unit.
- Any alterations or additions to building wiring **must be completed by a licensed electrician** or person authorised by legislation to work on the fixed wiring of any electrical installation.

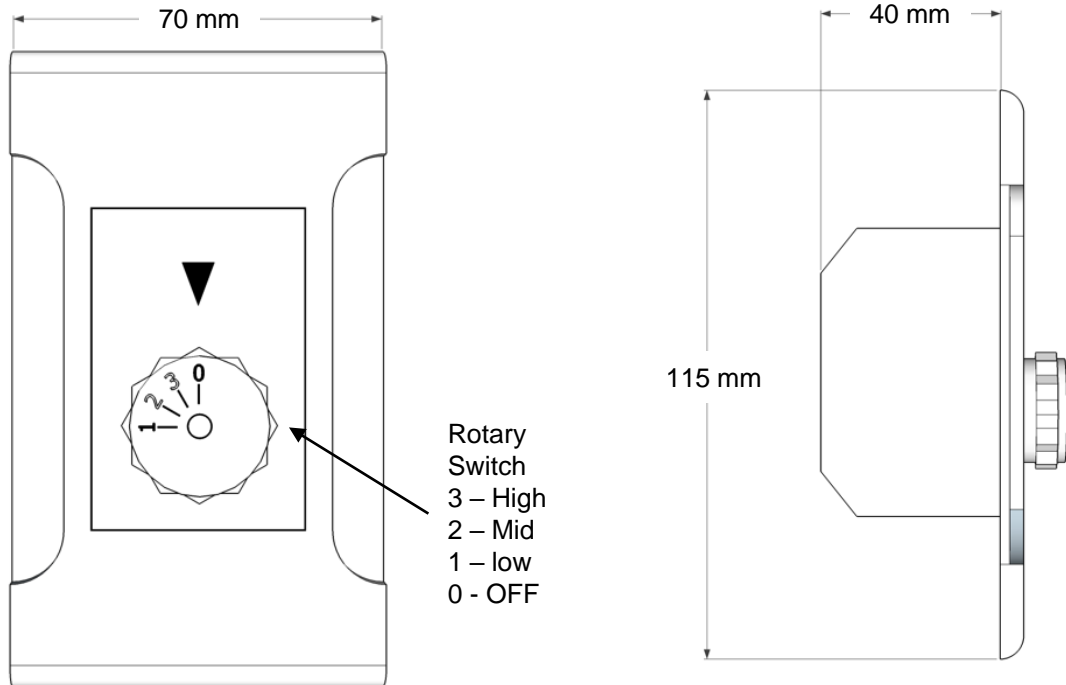

SPECIFICATION:			
Input Voltage:	220-240V AC 50Hz	Maximum no of Ceiling Fan can be connected:	4 same model & made ceiling fans ensure total power MUST NOT exceeded 260W
Max Output Voltage:	240V AC 50Hz		
Maximum Power:	260W	Dimension (H x W x D):	115 x 70 x 40 mm
Protection:	Class II	Weight:	0.110 kg

Before first using your new fitting, it is most important that you read and follow these instructions, even if you feel you are quite familiar with this type of product. Retain this document for future reference.

WARNINGS

- Installation, repair and/or inspection must be conducted by qualified personnel in accordance with Australian Standards and local Building codes.
- Care must be taken to ensure electrical wiring and other hidden utilities are not damaged when wall is cut.
- Do not operate this fitting in harsh environmental conditions such as building sites.
- Do not install it on surfaces which can move or vibrate.
- Do not allow children to play with wall switch turning ON/OFF rapidly.
- Ensure wire connections are firm.
- Do not attempt to perform modification or change parts within the unit.
- Dispose of packaging thoughtfully.

INSTALLATION

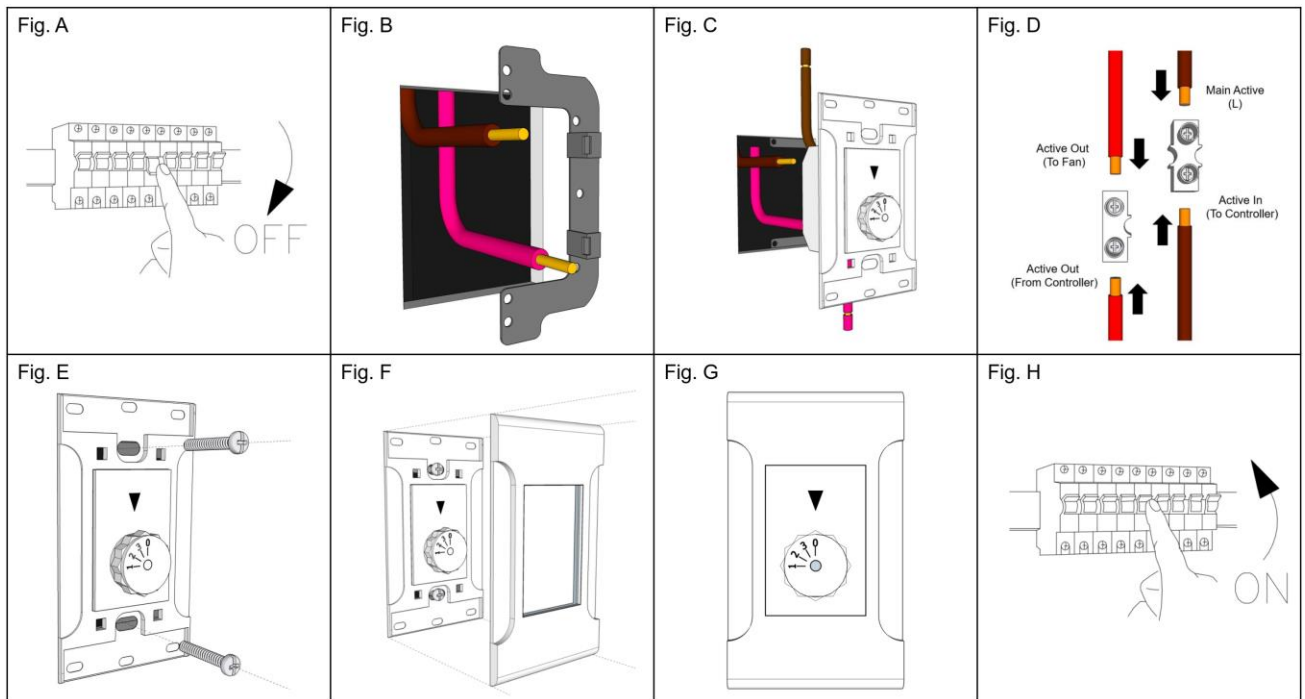

- 1) Ensure the Mains Supply is switched 'OFF'. (Fig. A)
- 2) Unpack the fixture carefully and place it on a flat surface. Dispose of the packaging material thoughtfully.
- 4) Cut a square hole and install a C-bracket. (Fig. B). **Note:** Exercise caution to avoid cutting into existing electrical wiring behind the wall!
- 5) For replacement existing wall controller with this multi fan controller device, the existing C-bracket mounting hole can be use to secure the unit.
- 6) Feed mains supply cable together with the fan wire through the wall. (Fig. C)
- 7) Connect the Main Active (L) & Fan wires according to the markings on the wires with the controller. Use appropriate terminal block size to joint the wires. (Fig. D) Ensure all connections are firm and secure. **Note: Ensure maximum total fan load are less than 260W.**
- 8) Use appropriate screws to attach the unit to the C-bracket securely. (Fig. E)
- 9) Attach the face plate to the main unit by push the face plate until you hear the clip sound. (Fig. F)
- 10) Installation completed. (Fig G)
- 11) Reconnect the mains supply. (Fig. H)
- 12) Turn the rotary switch to turn ON the Fan.



MULTI FAN CONTROLLER FOR AC CEILING FAN

Model No: 99777

TROUBLESHOOTING

TROUBLE	PROBABLE CAUSE	SUGGESTED REMEDY
Fan not start	A Fuse or circuit breaker has blown.	A Check main and branch circuit breakers.
	B Loose wire connections to the unit.	B Check all wire connections to the unit are secure & firmly.
	C Wiring not correctly at the unit.	C Check wiring at the unit is correctly. Live & Neutral wires are connected correctly at the unit.
Fan speed too fast even on lowest speed	A less number of fan connect to the device	A Ensure the device is connected to 4 fans with total load less than 260W.
	B Might be one or 2 fan is not working	B Check all the fans (4) connected and working properly
Humming sound come from one of the fan.	A Might be miss match the ceiling fans	A Ensure same model ceiling fan connected to the device.
	B Might be mix with different model ceiling fan.	B Ensure same model ceiling fan connected to the device.
	C Might be one of the fan motor not match with the controller	C Advice to swap the ceiling fan.

CARE & CLEANING

- Use a lint free cloth to avoid scratching the finish.
- Only use damp cloth to clean. DO NOT use any cleaning chemical.

ENVIRONMENTAL PROTECTION:

This electrical product should not be disposed as normal waste. Please always recycle! Check with your Local Council about your recycle options.





MULTI FAN CONTROLLER FOR AC CEILING FAN

Model No: 99777

Warranty:

Brilliant Lighting warrants this product against defects in manufacture and workmanship for a period of 1 year from date of purchase or as specified elsewhere (battery not included). For products used in non-domestic or commercial applications, Brilliant Lighting warrants this product for a period of 3 months from date of purchase. This warranty is only valid for products installed and operated within the guidelines specified by Brilliant Lighting, and within the correct operating voltage ranges as stated on the product's rating label.

Warranty does not include damage or loss arising from incorrect installation, operation or maintenance of this product, damage caused through modification, incorrect installation, service by unqualified or unauthorised personnel or lack of regular maintenance and cleaning. Proof of installation by qualified personnel may be required, e.g. Electrical Safety Certificate. Proof of purchase must be supplied with all warranty claims.

This warranty is provided in addition to any other rights and remedies of the customer under any law. In applications not intended for household, personal or domestic use, liability is limited to replacement or reimbursement of product only. Brilliant Lighting does not warranty the costs of removal or re-installation of this product or associated components.

Our goods come with guarantees that cannot be excluded under the Australian Consumer Law. You are entitled to a replacement or refund for a major failure and compensation for any other reasonably foreseeable loss or damage. You are also entitled to have the goods repaired or replaced if goods fail to be of acceptable quality and the failure does not amount to a major failure.

Any claim under this warranty must be made within the specified warranty period from date of purchase of this product. To make a claim under the warranty; at your own expense take the product (with proof of purchase – receipt or similar) to the store where you purchased the product or contact Brilliant Lighting at the address below.

This warranty is given by:

Brilliant Lighting (Aust) Pty. Ltd.
ABN 37 006 203 694
956 Stud Road Rowville, VIC 3178
Phone: 03 9765 2555
Email: warranty@brilliantlighting.com.au
Web: www.brilliantsmart.com.au
MADE IN CHINA