

Concept Wall Light Installation Instructions



Product Specifications

Model No.	HV8028W-BLK	HV8028C-BLK	HV8028W-WHT	HV8028C-WHT
Name				
Material	Aluminium			
Colour	Black + Gold Insert		White + Gold Insert	
Installation Type	Wall - Surface Mounted			
IP Rating	IP20			
Input Voltage	240V			
Protection Class	1 (Earth Required) ⚡			
Lamp Base	G9			
Lamp Wattage	2w (Max 25w)			
Colour Temp	3000k	5500k	3000k	5500k
Lumens	120lm	130lm	120lm	130lm
CRI	80+			
Dimmable	No			
Warranty	3 Years Replacement			

Dimensions

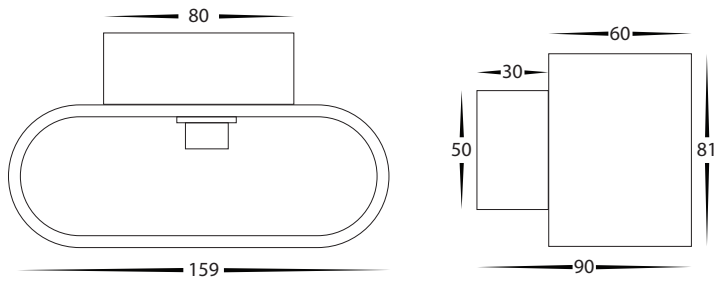

Mounting Base

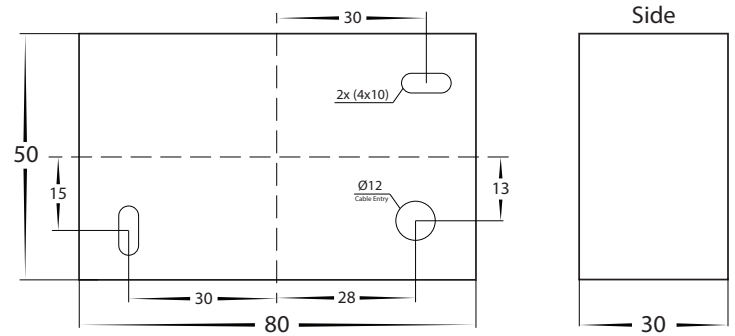

Important Safety Issues:

- This product must be installed by a qualified electrician according to AS/NZS 3000.
- Ensure all electrical mains are disconnected before any installation.
- Modification of this product will void any warranty.
- Havit Lighting does not take responsibility for wrong installation, incorrect use, or use of installation material that does not belong to the system.
- Aluminium and 304SS fittings must not be installed within 5km of any salt water environments.
- All o-rings and seals must be in place correctly to maintain warranty
- This form may be updated at any time due to product improvements, please check online installation form for most current version.

Steps for Installation:

1. Make sure that the electrical circuit is free of voltage (master switch off)
2. Remove Mounting Bracket from fitting by removing screws using Allen key.
3. Insert cable from wall into cable entry of bracket
4. Install mounting bracket in desired location using appropriate screws for application.
5. Connect the cable - use wire with earth; connect the earth first, then live and neutral wire.
6. Slide fitting back over bracket and tighten allen screws, Be careful not to overtighten
7. Insert globe into fitting
 - Align pins of globe into lampholder and gently push globe into place.
8. All connections must be carried out carefully, inspect all contacts before switching back on the electric circuit.

Steps for Changing Globe:

1. When Changing globes make sure not to exceed maximum wattage - Check product label for correct wattage.
 - Grab side of globe and gently pull until globe is dislodge from lampholder
 - Align pins of globe into lampholder and gently push globe into place.

Must be installed by a licensed electrician

Contact Details:

143 Beauchamp Road
Matraville NSW 2036
Australia

Tel: 02 9381 8300
Fax: 02 9666 8881
Email: sales@havit.com.au
Web: www.havit.com.au

Warranty Terms & Conditions*



Additional Information

